



DEC 3000
Model 500/500S AXP
Rackmount Installation

EK-D355S-IN. B01

April 1993

This guide is a support and reference document for Digital service personnel who install DEC 3000 AXP Model 500/500S rackmount systems. The guide is also intended for Digital customers who have a self-maintenance agreement with Digital.

This is a revised document.

Digital Equipment Corporation

First Edition, November 1992
Second Edition, April 1993

The information in this document is subject to change without notice and should not be construed as a commitment by Digital Equipment Corporation. Digital Equipment Corporation assumes no responsibility for any errors that may appear in this document.

Possession, use, duplication, or dissemination of the software described in this documentation is authorized only pursuant to a valid written license from Digital or the third-party owner of the software copyright.

No responsibility is assumed for the use or reliability of software on equipment that is not supplied by Digital Equipment Corporation.

Copyright © Digital Equipment Corporation 1992, 1993

All Rights Reserved.
Printed in U.S.A.

The following are trademarks of Digital Equipment Corporation: Alpha AXP, AXP, DEC, DIGITAL, TURBOchannel, and the DIGITAL logo.

Contents

Preface

1	Rackmount Installation for the IEC RS-310 Cabinet	
	Installation Procedure (IEC RS-310 Cabinet)	1-1
2	Rackmount Installation for the H9A00-AJ Cabinet	
	Installation Procedure (H9A00-AJ Cabinet)	2-1

Figures

1-1	Determining the Installation Area	1-3
1-2	Installing the Top Air Deflector	1-5
1-3	Installing the Bottom Air Deflector Assembly	1-7
1-4	Assembling the Right Side Chassis Slide Subassembly	1-11
1-5	Installing the Right Side Chassis Slide Assembly	1-13
1-6	Assembling the Left Side Chassis Slide Subassembly	1-15
1-7	Installing the Left Side Chassis Slide Assembly	1-17
1-8	Installing the Chassis Slide Support Brackets	1-19
1-9	Securing the PE50A-B9/D9 Unit to the Chassis Slide Assembly	1-21
1-10	Installing the Faceplate Mounting Brackets	1-23
1-11	Installing the Faceplate	1-25
1-12	Installing the Rear Support Bracket	1-27
1-13	Rear View of the System	1-29
1-14	Front View of the System	1-31
2-1	Determining the Installation Area	2-3
2-2	Installing the Top Air Deflector	2-5
2-3	Installing the Bottom Air Deflector Assembly	2-7
2-4	Assembling the Right Side Chassis Subassembly	2-11
2-5	Installing the Right Side Chassis Slide Assembly	2-13
2-6	Assembling of the Left Side Slide Subassembly	2-15
2-7	Installing the Left Side Chassis Slide Assembly	2-17
2-8	Installing the Chassis Slide Support Brackets	2-19
2-9	Securing the PE50A-B9/D9 Unit to the Chassis Slide Assembly	2-21
2-10	Installing the Faceplate Mounting Brackets	2-23
2-11	Installing the Faceplate	2-25
2-12	Installing the Rear Support Bracket	2-27
2-13	Rear View of the System	2-29

2-14 Front View of the System 2-31

Tables

1-1 DEC 3000 Model 500/500S AXP System (Rear) 1-30
1-2 DEC 3000 Model 500/500S AXP System (Front) 1-32
2-1 DEC 3000 Model 500/500S AXP System (Rear) 2-30
2-2 DEC 3000 Model 500/500S AXP System (Front) 2-32

Preface

About This Guide

Purpose and Audience

This guide is a support and reference document for Digital service personnel who install DEC 3000 AXP Model 500/500S rackmount systems. The guide is also intended for Digital customers who have a self-maintenance agreement with Digital.

Organization

This guide includes two chapters:

- Chapter 1 describes how to install the DEC 3000 Model 500/500S AXP system in an IEC RS-310 (RETMA) cabinet.
 - Chapter 2 describes how to install the DEC 3000 Model 500/500S AXP system in an H9A00-AJ cabinet.
-

Conventions Used in This Guide

This guide uses the following conventions:

Convention	Meaning
Note	Provides general information on the current topic.
Warning	Provides information to prevent personal injury.
❶	Circled numbers provide a link between figures and text.

Continued on next page

About This Guide , Continued

Related Documentation

The following documents provide additional information about the DEC 3000 Model 500/500S AXP system:

Document	Order Number
DEC 3000 AXP Model 500/500S Owner's Guide	EK-FLAMI-OM
DEC 3000 AXP Model 500/500S Options Installation Guide	EK-FLAMI-IG
DEC 3000 AXP Model 500/500S Service Information	EK-FLAMI-SV
DEC 3000 AXP Model 500/500S Technical Summary	EK-FLASA-TM

Chapter 1

Rackmount Installation for the IEC RS–310 Cabinet

Installation Procedure (IEC RS–310 Cabinet)

Overview

This chapter describes how to install a DEC 3000 Model 500 (PE50A–B9) or Model 500S (PE50A–D9) AXP rackmount system in an IEC RS–310 (RETMA) cabinet.

NOTE

The configurations that this procedure supports do not require a power controller.

Cabinet Location

The customer chooses the location to install the cabinet. When the location is identified, perform the following steps:

Steps	Action
1	Move the cabinet to the selected location.
2	Use an open end (spanner) wrench to screw down the cabinet leveler feet.
3	Place a spirit level on the cabinet base to ensure that the cabinet is level.
4	Readjust the leveler feet, if necessary, until the cabinet is level.
5	Slide out the stabilizer bar to support the weight of the system being installed.

Continued on next page

Installation Procedure (IEC RS-310 Cabinet), Continued

Determine the Installation Area in the Cabinet

To determine the installation area for the PE50A-B9/D9 unit in an IEC RS-310 cabinet, perform the following steps at the front and rear cabinet rails. See Figure 1-1.

WARNING

Digital does not recommend installing the system in the top area of the cabinet, for stability reasons.

The space between mounting holes in the cabinet rails follows a pattern of 0.50 inches (1.27 cm), 0.625 inches (1.59 cm), and 0.625 inches (1.59 cm). This pattern is repeated for the length of the rails.

Steps	Action
1	Select a section of the cabinet rail where there is a 0.50 inch (1.27 cm) space between two holes.
2	Make a mark between the holes. This is your starting point.
3	Count up or down three holes. This is one set and equals 1.75 inches (4.45 cm).
4	Count up or down nine sets and make a mark. The area between the marks is the installation area .

The total installation area is 15.75 inches (40.01 cm). The equation for calculating the total area is

$$1.75 \text{ inches (4.45 cm)} \times 9 \text{ sets} = 15.75 \text{ inches (40.01 cm)}$$

NOTE

The hole count described in this section will install the system in any predetermined 15.75-inch (40.01 cm) area.

Continued on next page

Installation Procedure (IEC RS-310 Cabinet), Continued

Figure 1-1 Determining the Installation Area

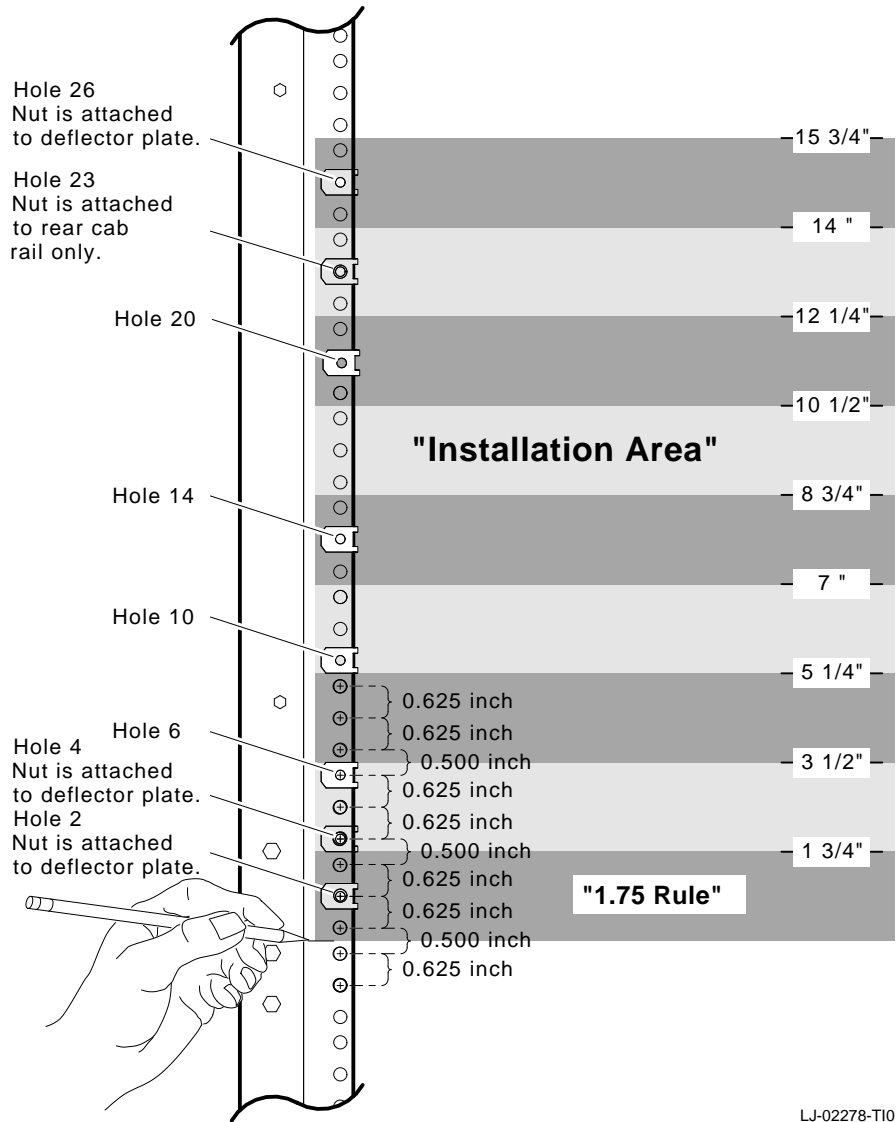

LJ-02278-T10

Continued on next page

Installation Procedure (IEC RS-310 Cabinet), Continued

Assemble the Top Air Deflector and Baffle Subassembly

Required materials:

- Six 6/32 screws
- Top air baffle (PN 74-46195-01)
- Top air deflector (PN 74-46196-01)

To assemble the top air deflector and baffle subassembly (Figure 1-2):

Steps	Action
1	Align the holes in the deflector ❶ to the holes in the baffle ❷.
2	Insert and tighten the six screws to secure the baffle to the deflector.

Install the Top Air Deflector Assembly

Required materials:

- Four 10/32 screws with integral washers
- Six clip nuts (PN 90-07786-00)
- Top air deflector assembly (assembled in previous section)

To install the top air deflector assembly (Figure 1-2):

Steps	Action
1	Attach clip nuts to each tab ❸ on the deflector as shown.
2	Count up 26 holes from the bottom of the installation area on the front and rear cabinet rails, as shown in Figure 1-1.
3	Use the four 10/32 screws to secure the top air deflector assembly to the cabinet rails.

Continued on next page

Installation Procedure (IEC RS-310 Cabinet), Continued

Figure 1-2 Installing the Top Air Deflector

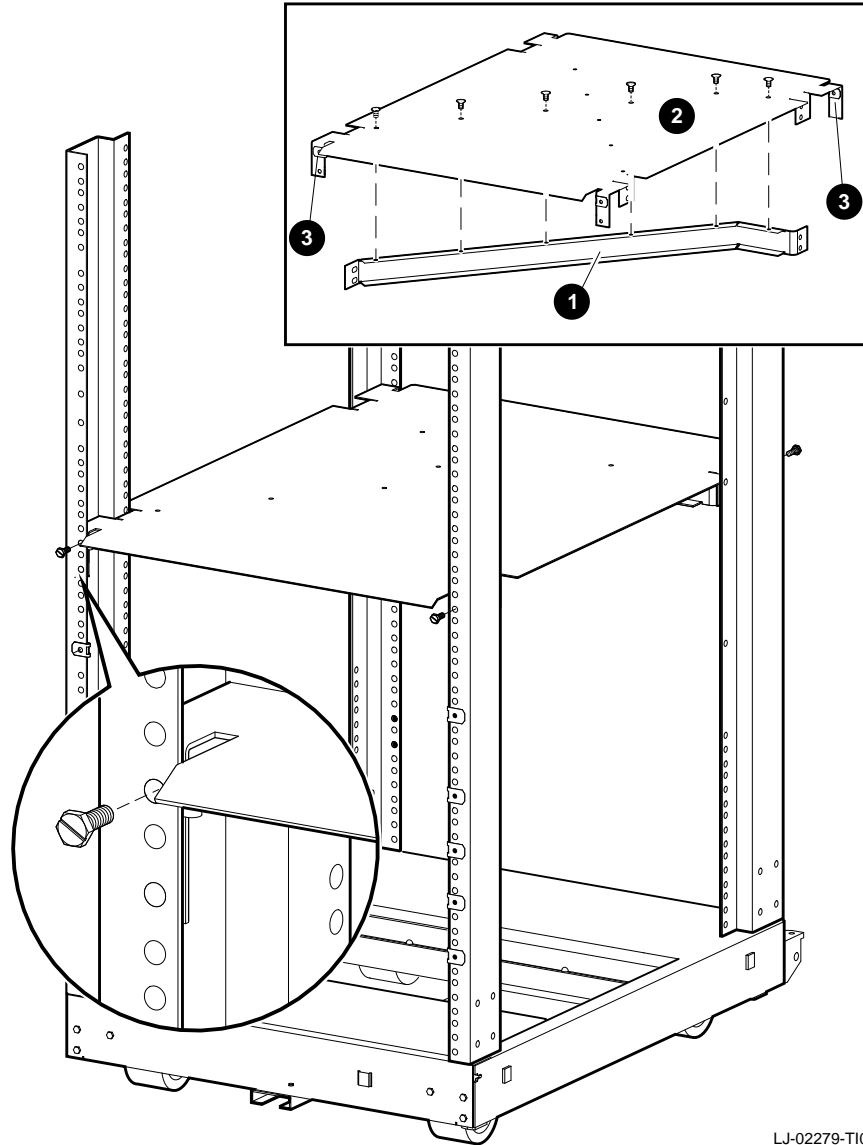

LJ-02279-T10

Continued on next page

Installation Procedure (IEC RS-310 Cabinet), Continued

Assemble the Bottom Air Deflector and Baffle Subassembly

Required materials:

- Six 6/32 screws
- Bottom air baffle (PN 74-46195-01)
- Bottom air deflector (PN 74-46208-01)

To assemble the bottom air deflector and baffle subassembly (Figure 1-3):

Steps	Action
1	Align the holes in the deflector ❶ to the holes in the baffle ❷.
2	Insert and tighten the six screws to secure the baffle to the deflector.

Continued on next page

Installation Procedure (IEC RS-310 Cabinet), Continued

Figure 1-3 Installing the Bottom Air Deflector Assembly

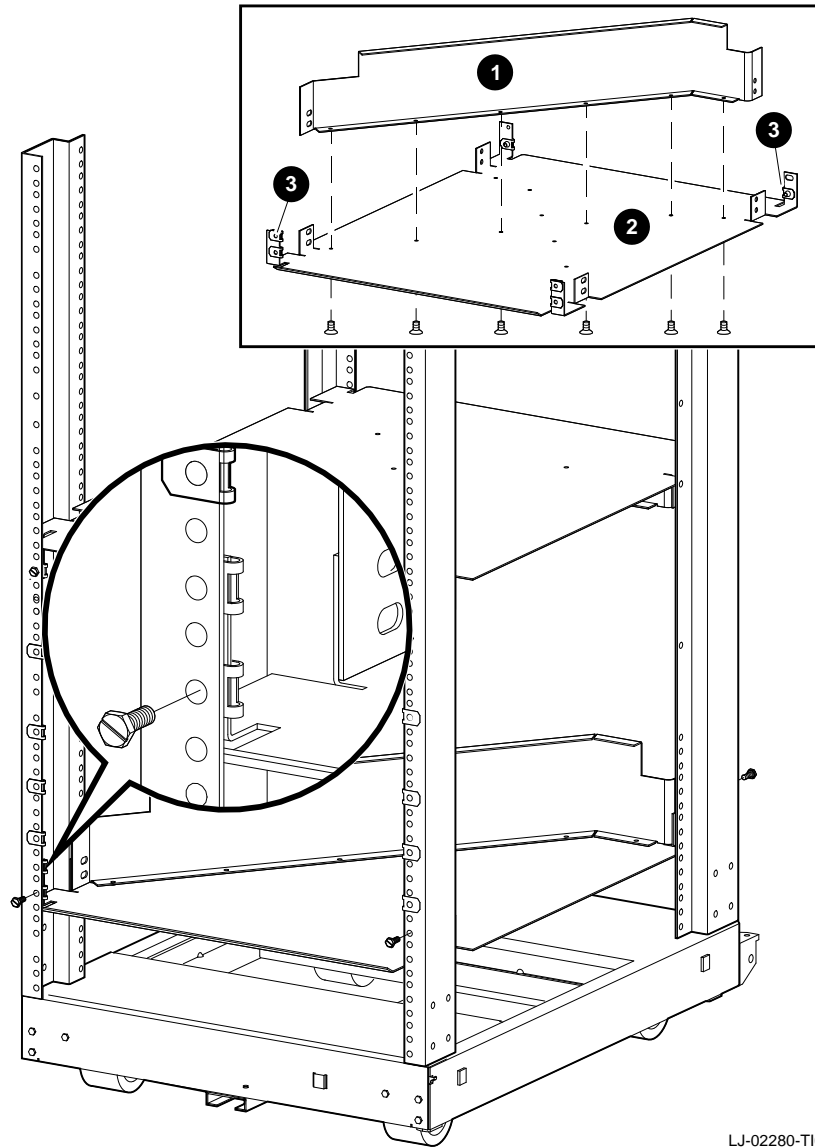

LJ-02280-T10

Continued on next page

Installation Procedure (IEC RS-310 Cabinet), Continued

Install the Bottom Air Deflector Assembly

Required materials:

- Four 10/32 screws with integral washers
- 14 clip nuts (PN 90-07786-00)
- Bottom air deflector assembly (assembled in the previous section)

To install the bottom air deflector assembly (Figure 1-3):

Steps	Action
1	Attach clip nuts to each tab ③ on the deflector as shown.
2	Count up four holes from the bottom of the installation area at the front of the cabinet and two holes at the rear of the cabinet.
3	Use the four 10/32 screws to secure the bottom air deflector assembly to the cabinet rails.
4	Install clip nuts in holes 6, 10, 14, and 20 on the front cabinet rails. Install clip nuts in holes 6, 10, 20, and 23 on the rear cabinet rails. See Figure 1-1.

Continued on next page

Installation Procedure (IEC RS-310 Cabinet), Continued

Assemble the Right Side Chassis Slide Subassembly

Required materials:

- Eight 8/32 screws
- Eight nuts
- Two slide mounting brackets (PN 74-46197-01)
- Chassis slide (PN 12-18166-02)
- Slide mounting angle brace (PN 74-45548-02)

NOTE

The slide mounting brackets have two mounting ends. One end is for IEC mounting, and the other is for metric mounting. See Figure 1-4.

Continued on next page

Installation Procedure (IEC RS-310 Cabinet), Continued

Assemble the Right Side Chassis Slide Subassembly (continued)

To assemble the right side chassis slide subassembly (Figure 1-4):

Steps	Action
1	Orient the slide mounting bracket ❶ so the IEC end is facing out.
2	Use four 8/32 screws to secure the slide mounting brackets to the chassis slide ❷. Do not tighten the two screws at the rear slide mounting bracket.
3	Use four 8/32 screws to secure the slide mounting angle brace ❸ to the chassis slide.

Continued on next page

Installation Procedure (IEC RS-310 Cabinet), Continued

Figure 1-4 Assembling the Right Side Chassis Slide Subassembly

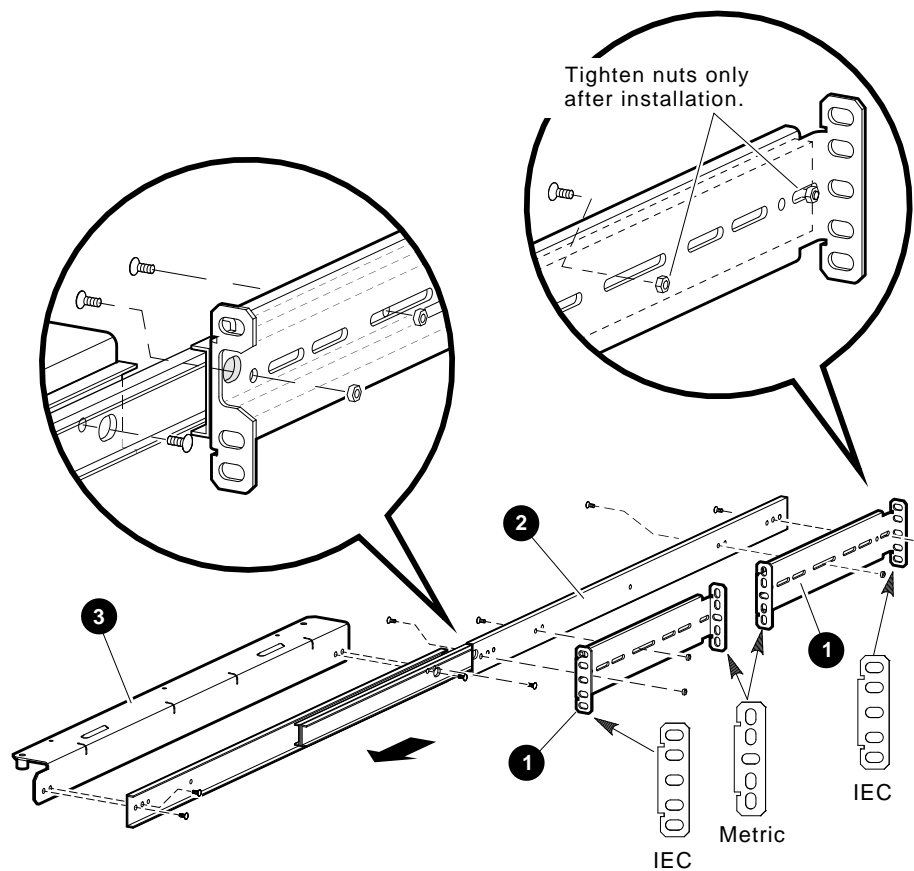

LJ-02537-T10

Continued on next page

Installation Procedure (IEC RS-310 Cabinet), Continued

Install the Right Side Chassis Slide Assembly

Required materials:

- Right side chassis slide assembly (assembled in the previous section)
- Two 10/32 screws

To install the right side chassis slide assembly (Figure 1-5):

Steps	Action
1	Count up 6 holes from the bottom of the installation area on the front and rear cabinet rails.
2	Count up 10 holes from the bottom of the installation area on the front and rear cabinet rails.
3	Align the chassis slide assembly ❶ to the sixth and tenth hole, then secure the assembly to the cabinet rails ❷.
4	Tighten the two screws on the rear slide mounting bracket.

Continued on next page

Installation Procedure (IEC RS-310 Cabinet), Continued

Figure 1-5 Installing the Right Side Chassis Slide Assembly

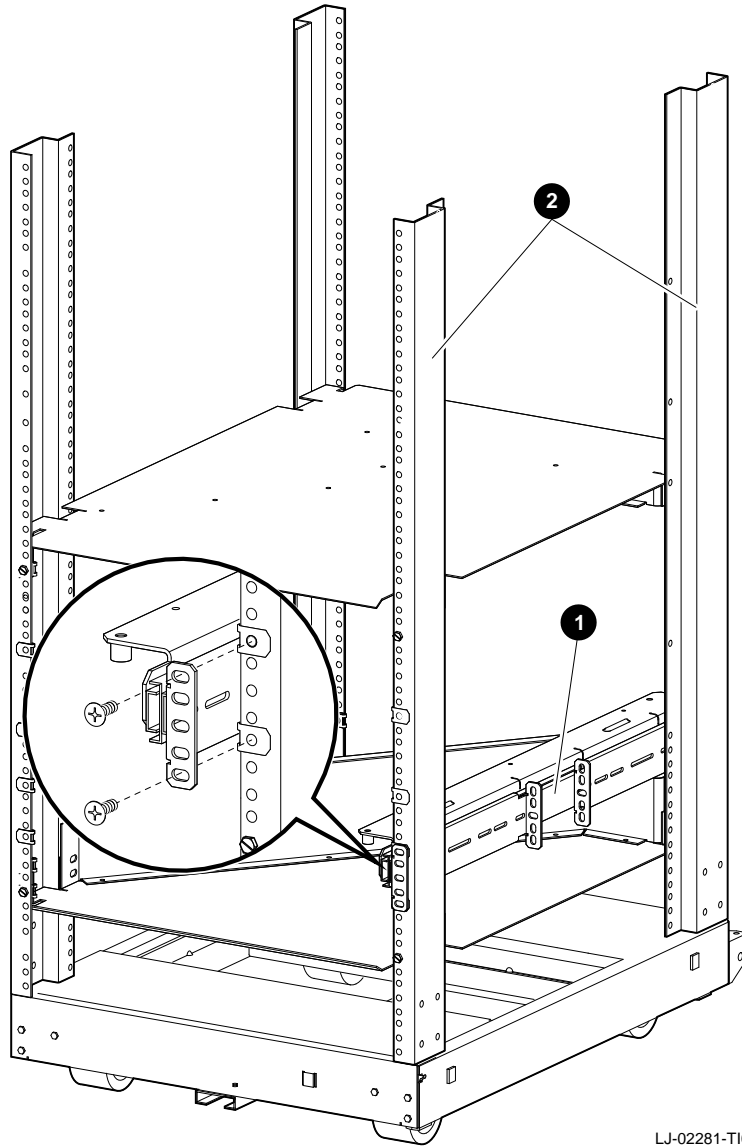

Continued on next page

Installation Procedure (IEC RS-310 Cabinet), Continued

Assemble the Left Side Chassis Slide Subassembly

Required materials:

- Eight 8/32 screws
- Eight nuts
- Two slide mounting brackets (PN 74-46197-01)
- Chassis slide (PN 12-18166-02)
- Slide mounting angle brace (PN 74-45548-01)

NOTE

The slide mounting brackets have two mounting ends. One end is for IEC mounting, and the other is for metric mounting. See Figure 1-6.

To assemble the left side chassis slide subassembly (Figure 1-6):

Steps	Action
1	Orient the slide mounting bracket ❶ so the IEC end is facing out.
2	Use four 8/32 screws to secure the slide mounting brackets to the chassis slide ❷. Do not tighten the two screws at the rear slide mounting bracket.
3	Use four 8/32 screws to secure the slide mounting angle brace ❸ to the chassis slide.

Continued on next page

Installation Procedure (IEC RS-310 Cabinet), Continued

Figure 1-6 Assembling the Left Side Chassis Slide Subassembly

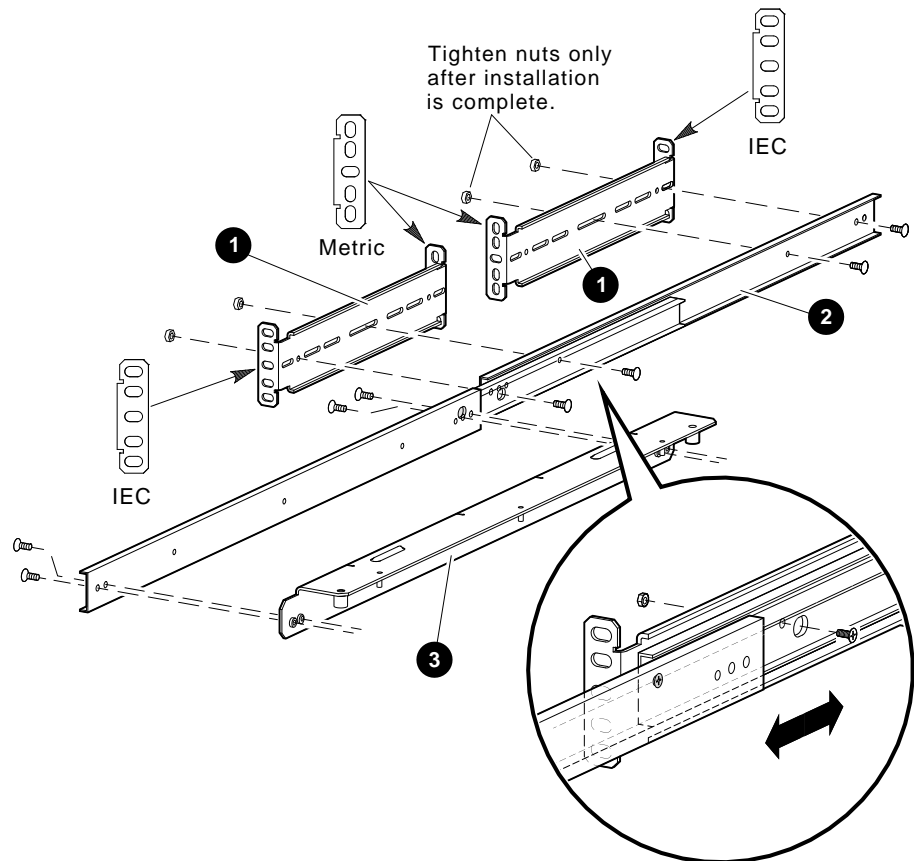

LJ-02538-T10

Continued on next page

Installation Procedure (IEC RS-310 Cabinet), Continued

Install the Left Side Chassis Slide Assembly

Required materials:

- Left side chassis slide assembly (assembled in the previous section)
- Two 10/32 screws

To install the left side chassis slide assembly (Figure 1-7):

Steps	Action
1	Count up 6 holes from the bottom of the installation area on the front and rear cabinet rails.
2	Count up 10 holes from the bottom of the installation area on the front and rear cabinet rails.
3	Align the chassis slide assembly ❶ to the sixth and tenth hole, then secure the assembly to the cabinet rails ❷.
4	Tighten the two screws at the rear slide mounting bracket.

Continued on next page

Installation Procedure (IEC RS-310 Cabinet), Continued

Figure 1-7 Installing the Left Side Chassis Slide Assembly

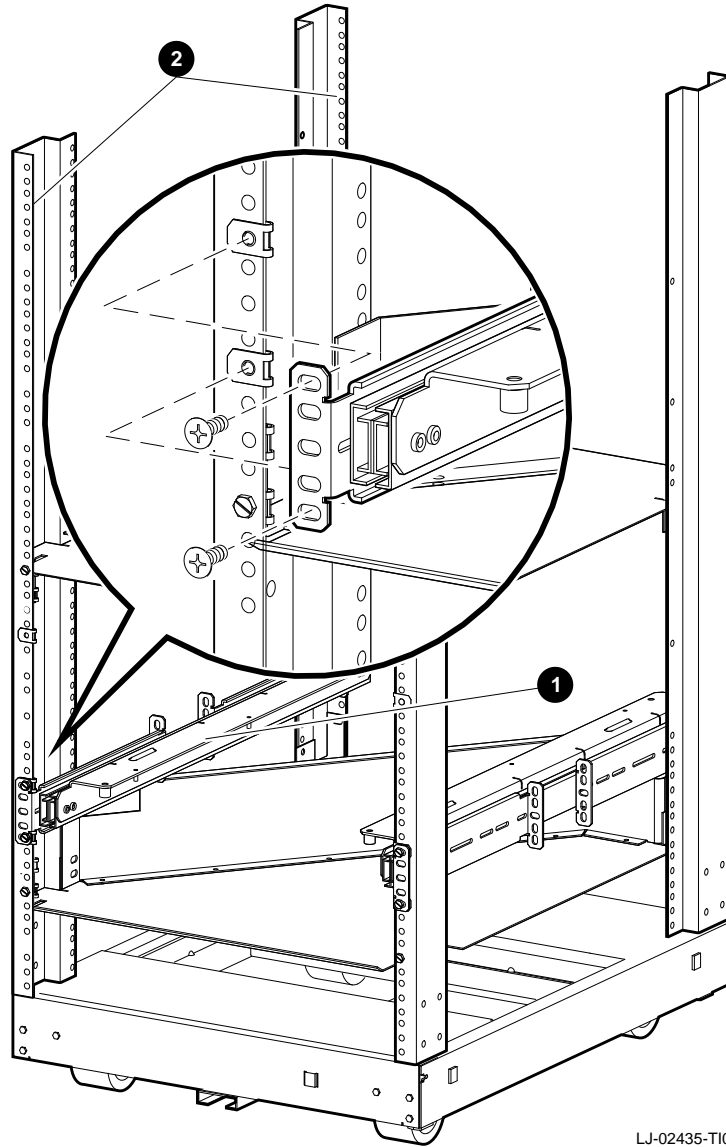

LJ-02435-T10

Continued on next page

Installation Procedure (IEC RS-310 Cabinet), Continued

Install the Chassis Slide Support Brackets

Required materials:

- Three support brackets (PN 74-45547-01)
- Six nuts

To install the chassis slide support brackets (Figure 1-8):

Steps	Action
1	Slide out the stabilizer bar ³ to support the weight of the system being installed.
2	Fully extend both chassis slide assemblies ¹ .
3	Use the six nuts to secure the three support brackets ² to the chassis slide assemblies. Do not tighten the nuts.

Continued on next page

Installation Procedure (IEC RS-310 Cabinet), Continued

Figure 1-8 Installing the Chassis Slide Support Brackets

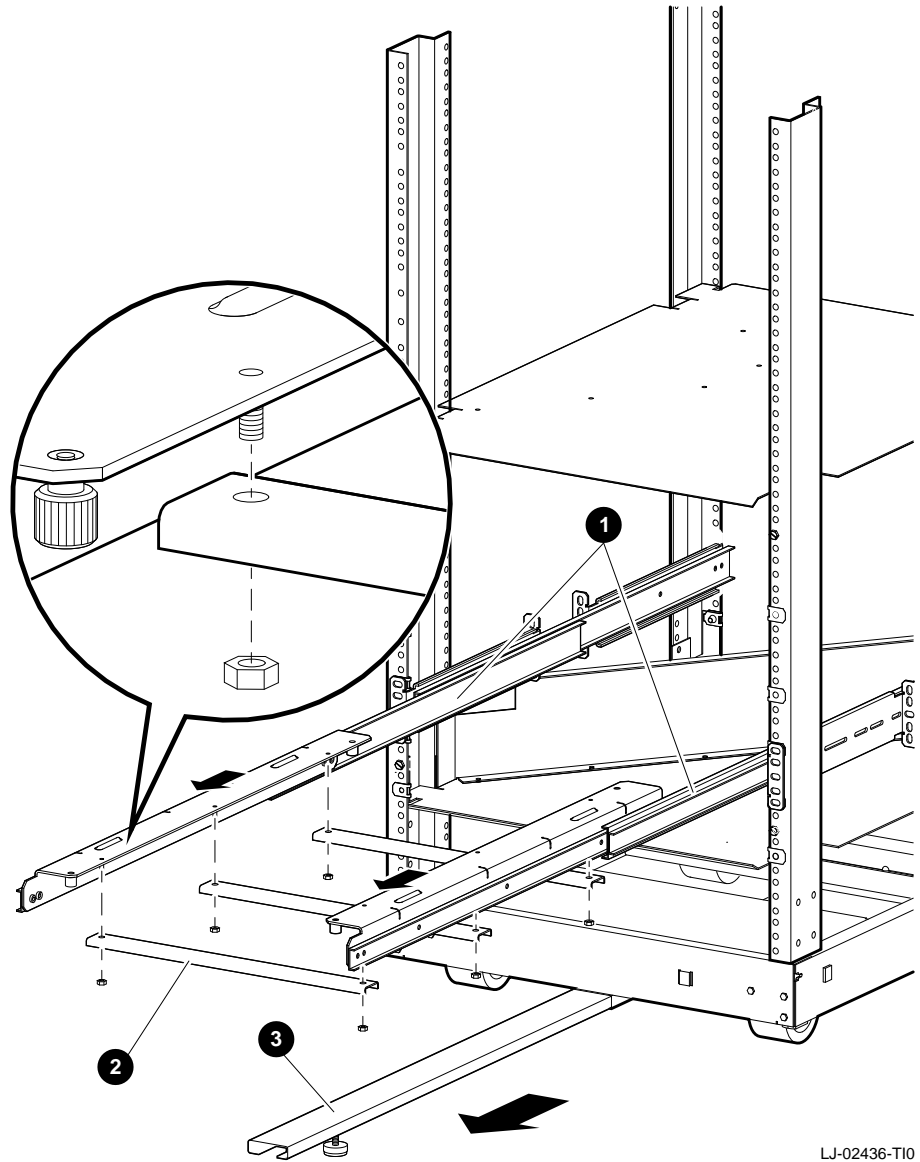

LJ-02436-T10

Continued on next page

Installation Procedure (IEC RS–310 Cabinet), Continued

Secure the
PE50A–B9/D9
Unit to the
Chassis Slide
Assembly

WARNING

Two people are required to install the system. Failure to do so could cause personal injury.

Digital does not recommend installing the PE50A–B9/D9 unit in the top area of the IEC RS–310 (RETMA) cabinet, for stability reasons.

To secure the PE50A–B9/D9 unit to the chassis slide assembly (Figure 1–9):

Steps	Action
1	Slide out the stabilizer bar (if not already out) to support the weight of the system being installed.
2	Slide out both chassis slide assemblies ② (if not already out) until they are fully extended.
3	Use two people to carefully lift the PE50A–B9/D9 unit ① and place it on the extended chassis slide assemblies ②.
4	Secure the PE50A–B9/D9 unit to the assemblies, using the four thumb screws at the bottom of the assemblies.
5	Tighten the six nuts securing the chassis slide support brackets to the assemblies.
6	Do not push the PE50A–B9/D9 unit into the cabinet.

Continued on next page

Installation Procedure (IEC RS-310 Cabinet), Continued

Figure 1-9 Securing the PE50A-B9/D9 Unit to the Chassis Slide Assembly

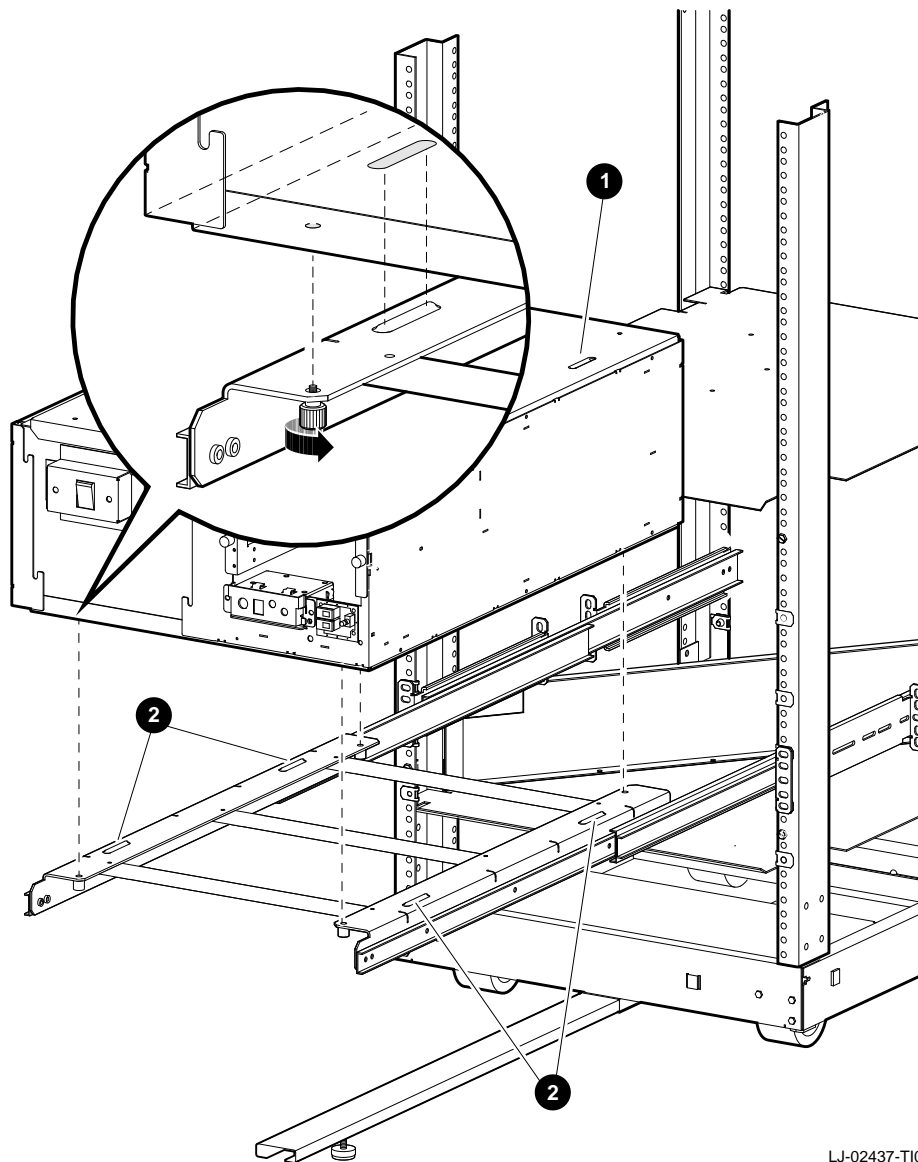

LJ-02437-T10

Continued on next page

Installation Procedure (IEC RS-310 Cabinet), Continued

Install the Faceplate Mounting Brackets

Required materials:

- Two 6/32 screws
- Six 10/32 screws
- Right mounting bracket (PN 74-45544-01)
- Left mounting bracket (PN 74-45543-01)

To install the faceplate mounting brackets Figure 1-10):

Steps	Action
1	Use the two 6/32 screws to secure the right faceplate mounting brackets ❶ to the system ❷. The left faceplate bracket is secured using screws that are already in place on the power supply.
2	Count up 2 holes, 14 holes, and 20 holes from the bottom of the installation area on the front cabinet rails.
3	Install clip nuts at the locations determined in step 2 (if not already installed).
4	Push the PE50A-B9/D9 unit into the cabinet.
5	Use the six 10/32 screws to secure the faceplate mounting brackets❶ to the cabinet.

Continued on next page

Installation Procedure (IEC RS-310 Cabinet), Continued

Figure 1-10 Installing the Faceplate Mounting Brackets

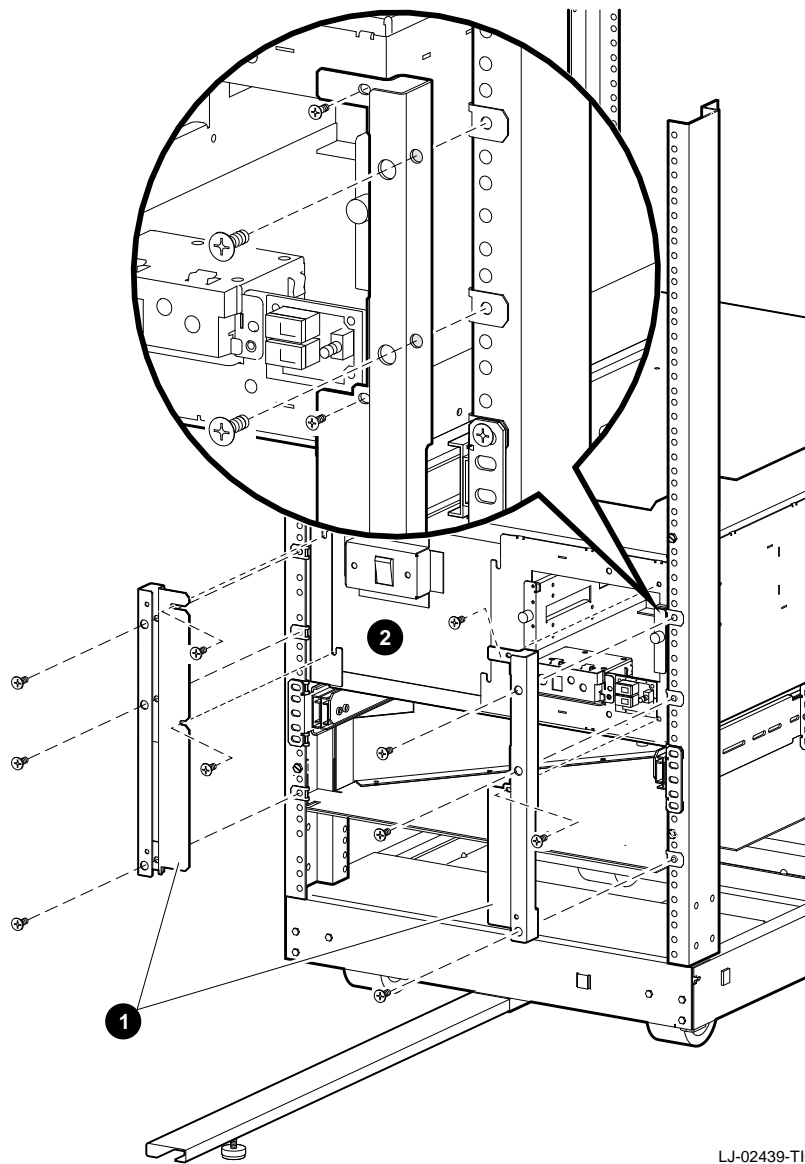

LJ-02439-T10

Continued on next page

Installation Procedure (IEC RS-310 Cabinet), Continued

Install the System Faceplate

To install the faceplate (PN 70-30322-01), snap the faceplate onto the taps at the front of the system (Figure 1-11).

NOTE

In Figure 1-11, the faceplate has two option inserts. The bottom insert is for an RZ26 drive. The top insert is a blank, used when no other drive is installed with the RZ26.

Continued on next page

Installation Procedure (IEC RS-310 Cabinet), Continued

Figure 1-11 Installing the Faceplate

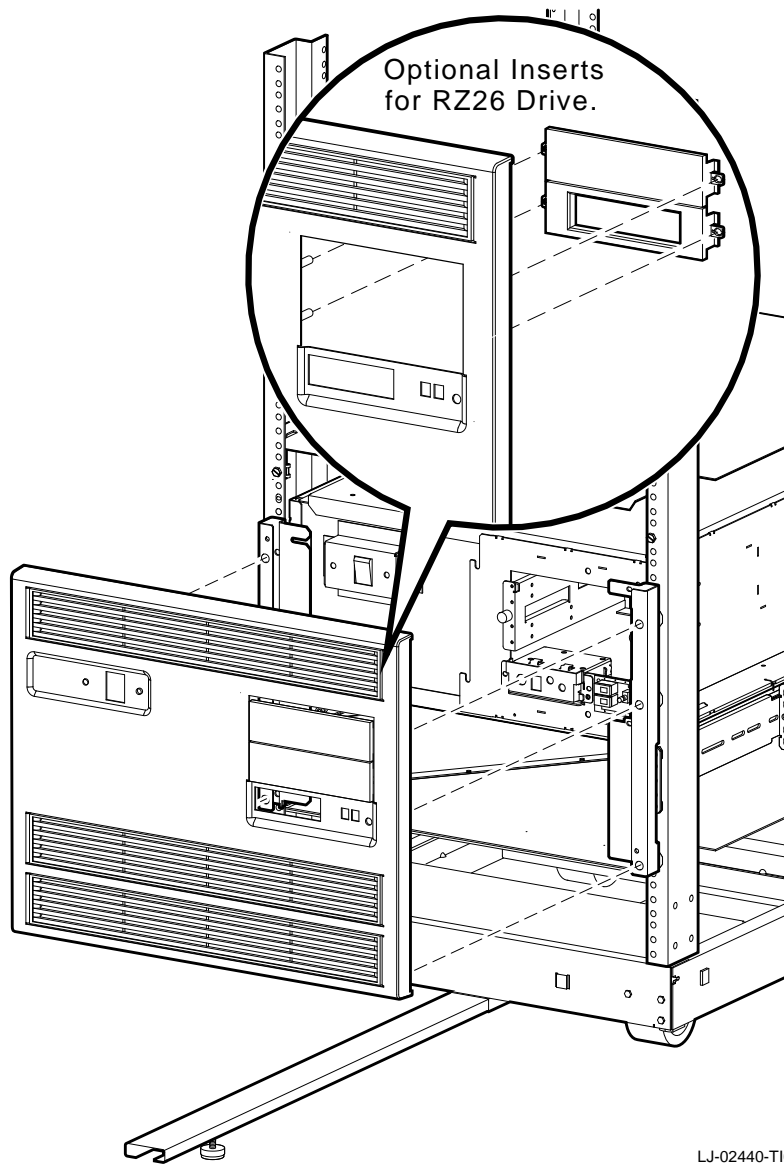

Continued on next page

Installation Procedure (IEC RS-310 Cabinet), Continued

Install the Rear Support Bracket

Required materials:

- Two 6/32 screws
- Rear support bracket (PN 74-45545-02)
- Four 10/32 screws

To install the rear support bracket (Figure 1-12):

Steps	Action
1	On the rear cabinet rails, count up 20 holes and 26 holes from the bottom of the installation area. Install clip nuts on these holes, if not already installed.
2	Use the two 6/32 screws to secure the rear support bracket ❶ to the rear of the PE50A-B9/D9 unit ❷.
3	Use the four 10/32 screws to secure the rear support bracket to the rear of the cabinet.

Continued on next page

Installation Procedure (IEC RS-310 Cabinet), Continued

Figure 1-12 Installing the Rear Support Bracket

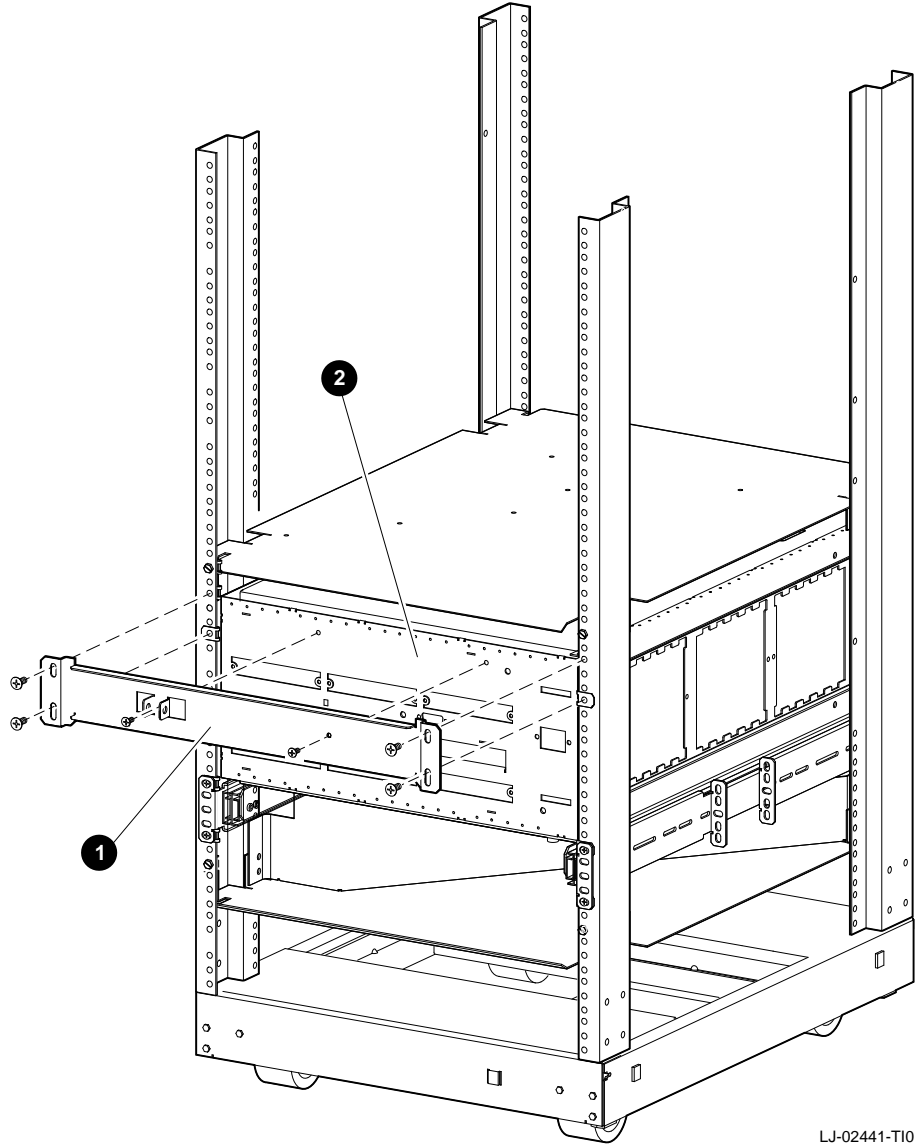

LJ-02441-T10

Continued on next page

Installation Procedure (IEC RS-310 Cabinet), Continued

Power and Cabling

Figure 1-13 shows the rear connectors, switches, and option slots on the DEC 3000 Model 500/500S AXP system. Table 1-1 describes these items.

Figure 1-14 shows the front switches, lights, jacks, and removable media slots. Table 1-2 describes these items.

To connect the system cables (Figure 1-13):

Steps	Action
1	Connect the keyboard/mouse cable ⑤.
2	Connect the monitor cable ⑩.
3	Connect power cord ⑫. There is no power controller.
4	Connect any other necessary cables.

Continued on next page

Installation Procedure (IEC RS-310 Cabinet), Continued

Figure 1-13 Rear View of the System

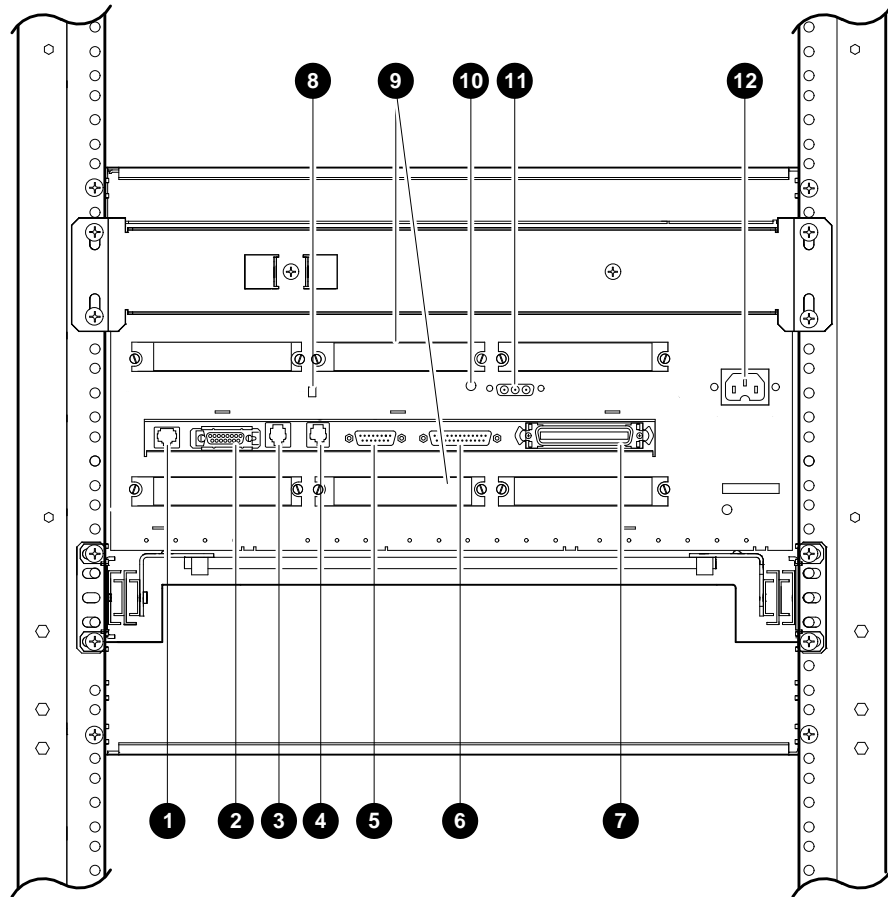

LJ-02442-T10

Continued on next page

Installation Procedure (IEC RS-310 Cabinet), Continued

Table 1-1 DEC 3000 Model 500/500S AXP System (Rear)

This Feature...	Lets You...
❶ 10baseT port	Connect a 10baseT (twisted-pair) Ethernet network cable.
❷ AUI Ethernet port	Connect an AUI (thickwire) Ethernet network cable.
❸ ISDN port	Connect an ISDN network cable.
❹ Printer/alternate console port	Connect a printer or an alternate console.
❺ Keyboard/mouse port	Connect the keyboard/mouse cable.
❻ Synch/asynch communications	Connect to a communication device, such as a modem.
❼ External SCSI port	Connect Small Computer System Interface (SCSI) peripheral devices.
❽ Printer/alternate console switch	Select the function of the printer /alternate console port.
❾ Six TURBOchannel slots	Install TURBOchannel option modules. (There are three designated slots for the I/O module and three slots for the system module.)
❿ Video refresh switch	Choose the correct video refresh rate (66Hz or 72Hz) for the monitor.
⓫ Monitor port	Connect the monitor video cable.
⓬ System power port	Connect the system power cord. (The port is keyed.)

Continued on next page

Installation Procedure (IEC RS-310 Cabinet), Continued

Figure 1-14 Front View of the System

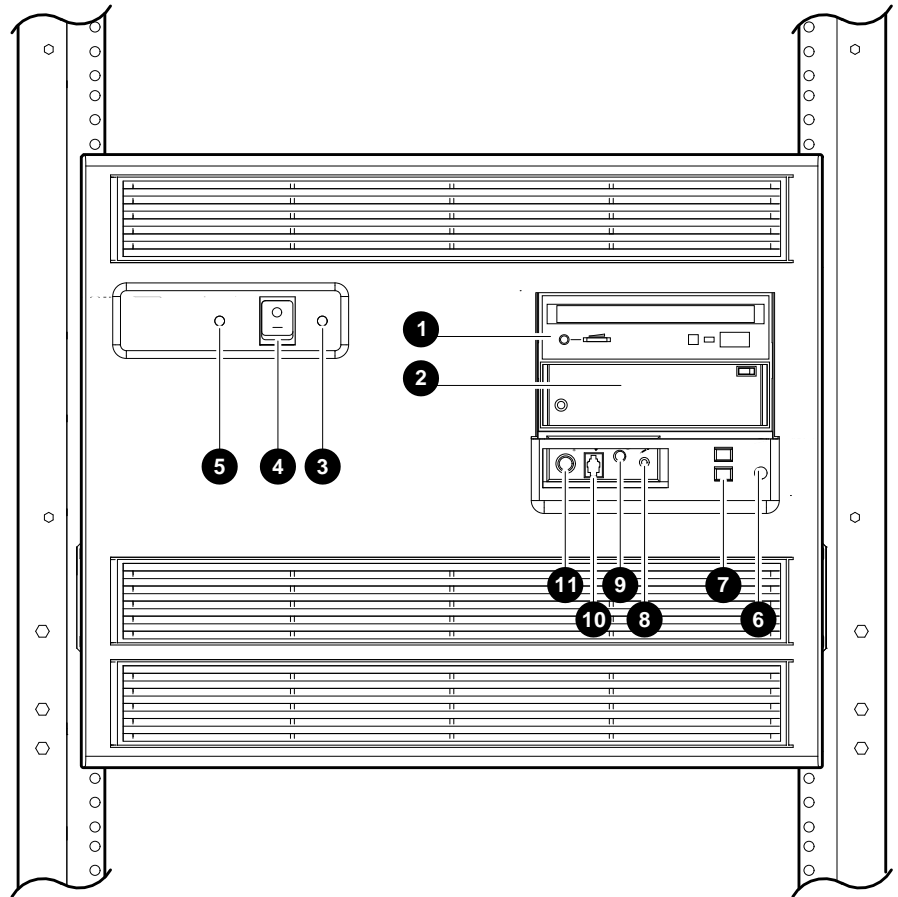

LJ-02536-T10

Continued on next page

Installation Procedure (IEC RS-310 Cabinet), Continued

Table 1-2 DEC 3000 Model 500/500S AXP System (Front)

This Feature...	Lets You...
❶ and ❷ Removable-media area	Access devices that use removable storage media such as diskettes, compact discs, cassette tapes, or cartridge tapes.
❸ DC OK light	Check that all dc voltages are present on the power supply.
❹ On/Off switch	Turn the system on and off (0).
❺ Fan indicator light	Check whether a fan has failed.
❻ Halt button	Put the system in console mode.
❼ Diagnostic display	View error codes that may indicate potential problems with the system.
❽ Microphone input jack	Connect a microphone to the system.
❾ Speaker output jack	Connect a speaker or headphone for audio output.
❿ Telephone jack	Connect a telephone handset.
⓫ Audio input jack	Connect an audio input line.

Verify the System

For system verification, refer to *DEC 3000 Model 500/500S AXP Service Information*.

Chapter 2

Rackmount Installation for the H9A00–AJ Cabinet

Installation Procedure (H9A00-AJ Cabinet)

Overview

This chapter describes how to install the DEC 3000 Model 500 (PE50A–B9) or Model 500S (PE50A–D9) AXP rackmount system in an H9A00-AJ cabinet.

NOTE

The configurations that this procedure supports do not require a power controller.

Cabinet Location

The customer chooses the location to install the cabinet. When the location is identified, perform the following steps:

Steps	Action
1	Move the cabinet to the selected location.
2	Use an open end (spanner) wrench to screw down the cabinet leveler feet.
3	Place a spirit level on the cabinet base to ensure that the cabinet is level.
4	Readjust the leveler feet (if necessary) until the cabinet is level.
5	Slide out the stabilizer bar to support the weight of the system being installed.

Continued on next page

Installation Procedure (H9A00-AJ Cabinet), Continued

Determine the Installation Area in the Cabinet

To determine the installation area for the PE50A–B9/D9 unit in an H9A00–AJ cabinet, perform the following steps at the front and rear cabinet rails. See Figure 2–1.

WARNING

Digital does not recommend installing the system in the top area of the cabinet, for stability reasons.

The space between mounting holes in the cabinet rails follows a pattern of 0.50 inches (1.27 cm), 0.625 inches (1.59 cm), and 0.625 inches (1.59 cm). This pattern is repeated for the length of the rails.

Steps	Action
1	Select a section of the cabinet rail where there is a 0.50 inch (1.27 cm) space between two holes.
2	Make a mark between the holes. This is your starting point.
3	Count up or down three holes. This is one set and equals 1.75 inches (4.45 cm).
4	Count up or down 10 sets and make a mark. The area between the marks is the installation area .

The total installation area is 17.50 inches (44.45 cm). The equation for calculating the total area is

$$1.75 \text{ inches (4.45 cm)} \times 10 \text{ sets} = 17.50 \text{ inches (44.45 cm)}$$

NOTE

The hole count described in this section will install the system in any predetermined 17.50-inch (44.45 cm) area.

Continued on next page

Installation Procedure (H9A00-AJ Cabinet), Continued

Figure 2-1 Determining the Installation Area

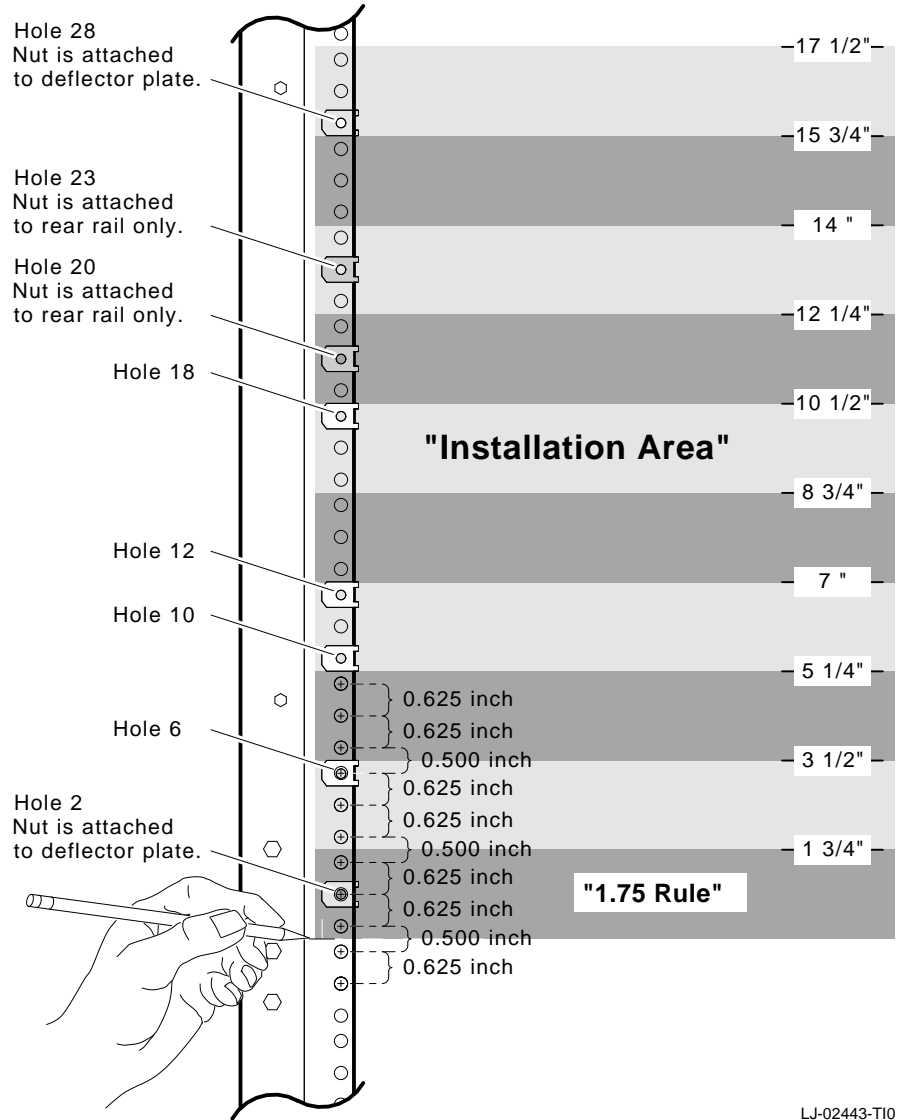

Continued on next page

Installation Procedure (H9A00-AJ Cabinet), Continued

Assemble the Top Air Deflector and Baffle Subassembly

Required materials:

- Six 6/32 screws
- Top air baffle (PN 74-46159-01)
- Top air deflector (PN 74-46157-01)

To assemble the top air deflector and baffle subassembly (Figure 2-2):

Steps	Action
1	Align the holes in the deflector ❶ to the holes in the baffle ❷.
2	Insert and tighten the six screws to secure the baffle to the deflector.

Install the Top Air Deflector Assembly

Required materials:

- Four 10/32 screws with integral washers
- Four clip nuts (PN 90-07786-00)
- Top air deflector assembly (assembled in the previous section)

To install the top air deflector assembly (Figure 2-2):

Steps	Action
1	Attach one clip nut to each tab ❸ on the deflector.
2	Count up 28 holes from the bottom of the installation area on the front and rear cabinet rails, as shown in Figure 2-1.
3	Use the four 10/32 screws to secure the top air deflector assembly to the cabinet rails.

Continued on next page

Installation Procedure (H9A00-AJ Cabinet), Continued

Figure 2-2 Installing the Top Air Deflector

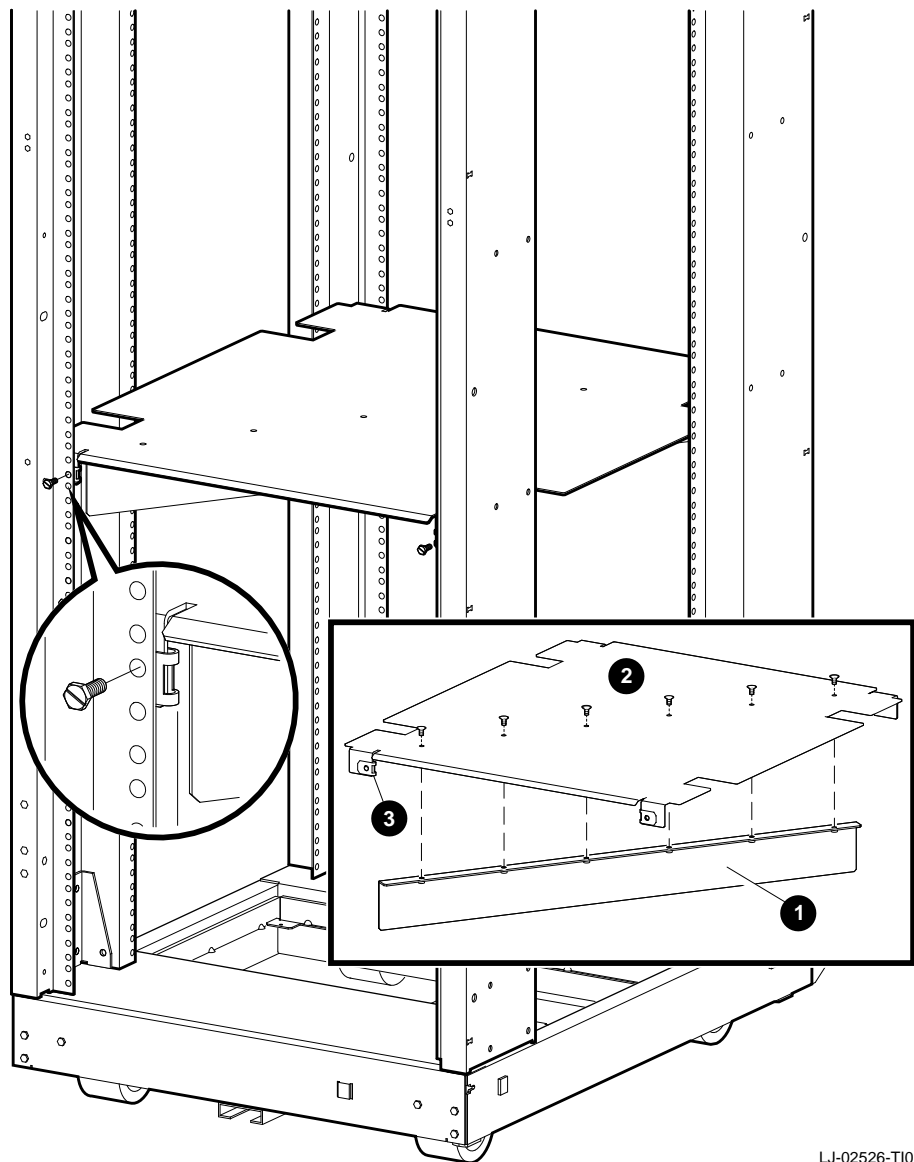

LJ-02526-T10

Continued on next page

Installation Procedure (H9A00-AJ Cabinet), Continued

Assemble the Bottom Air Deflector and Baffle Subassembly

Required materials:

- Six 6/32 screws
- Bottom air baffle (PN 74-46159-01)
- Bottom air deflector (PN 74-46158-01)

To assemble the bottom air deflector and baffle subassembly (Figure 2-3):

Steps	Action
1	Align the holes in the deflector ❶ to the holes in the baffle ❷.
2	Insert and tighten the six screws to secure the baffle to the deflector.

Continued on next page

Installation Procedure (H9A00-AJ Cabinet), Continued

Figure 2-3 Installing the Bottom Air Deflector Assembly

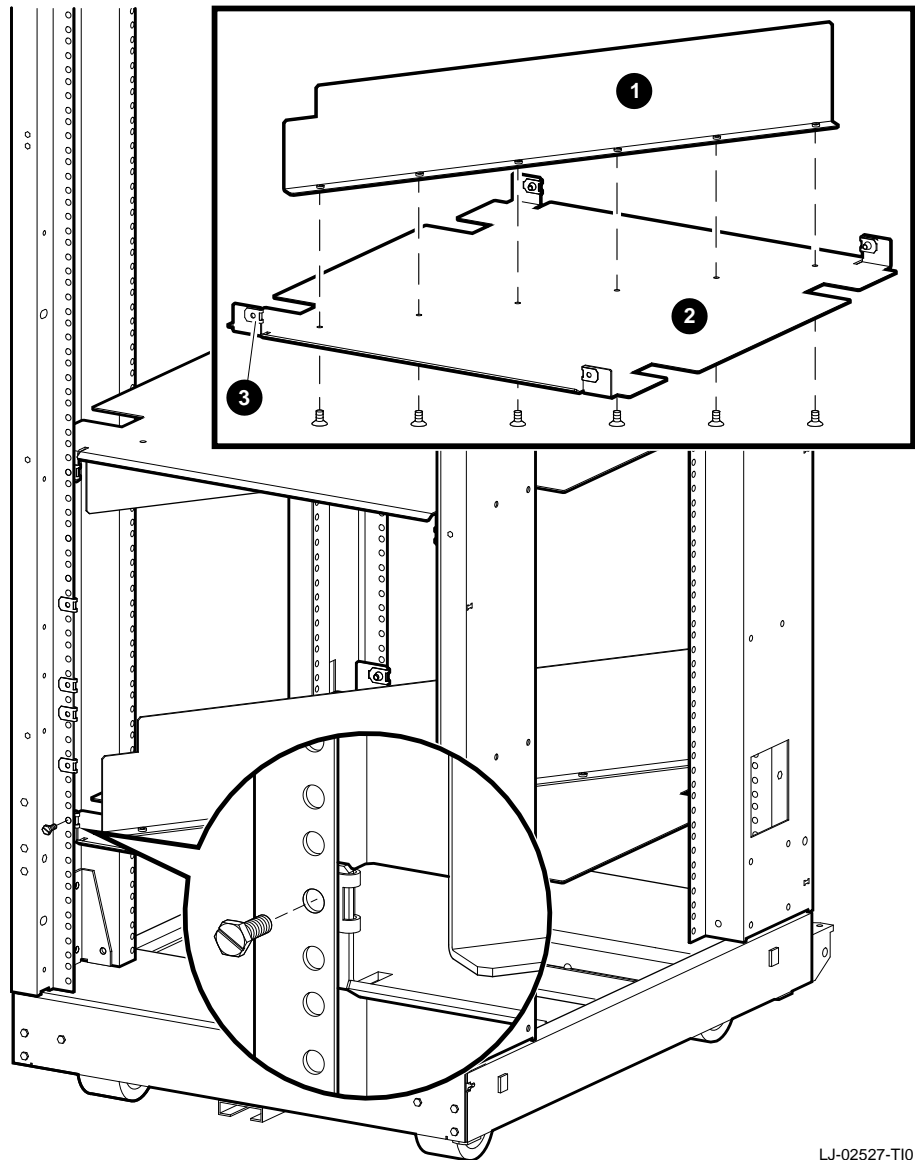

LJ-02527-T10

Continued on next page

Installation Procedure (H9A00-AJ Cabinet), Continued

Install the Bottom Air Deflector Assembly

Required materials:

- Four 10/32 screws with integral washers
- 12 clip nuts (PN 90-07786-00)
- Bottom air deflector assembly (assembled in the previous section)

To install the bottom air deflector assembly (Figure 2-3):

Steps	Action
1	Attach one clip nut to each tab ③ on the deflector, as shown in Figure 2-3.
2	Count up two holes from the bottom of the installation area on the front and rear cabinet rails.
3	Use the four 10/32 screws to secure the bottom air deflector assembly to the cabinet rails.
4	Install clip nuts in holes 6, 10, 12, and 18 on the front cabinet rails. Install clip nuts in holes 6, 10, 20, and 23 on the rear cabinet rails. See Figure 2-1.

Continued on next page

Installation Procedure (H9A00-AJ Cabinet), Continued

Assemble the Right Side Chassis Slide Subassembly

Required materials:

- Eight 8/32 screws
- Eight nuts
- Two slide mounting brackets (PN 74-46197-01)
- Chassis slide (PN 12-18166-02)
- Slide mounting angle brace (PN 74-45548-02)

NOTE

The slide mounting brackets have two mounting ends. One end is for IEC mounting, and the other is for metric mounting. See Figure 2-4.

Continued on next page

Installation Procedure (H9A00-AJ Cabinet), Continued

Assemble the Right Side Chassis Slide Subassembly (continued)

To assemble the right side chassis slide subassembly (Figure 2-4):

Steps	Action
1	Orient the slide mounting bracket ❶ so the IEC end is facing out.
2	Use four 8/32 screws to secure the slide mounting brackets to the chassis slide ❷. Do not tighten the two screws at the rear slide mounting bracket.
3	Use four 8/32 screws to secure the slide mounting angle brace ❸ to the chassis slide.

Continued on next page

Installation Procedure (H9A00-AJ Cabinet), Continued

Figure 2-4 Assembling the Right Side Chassis Subassembly

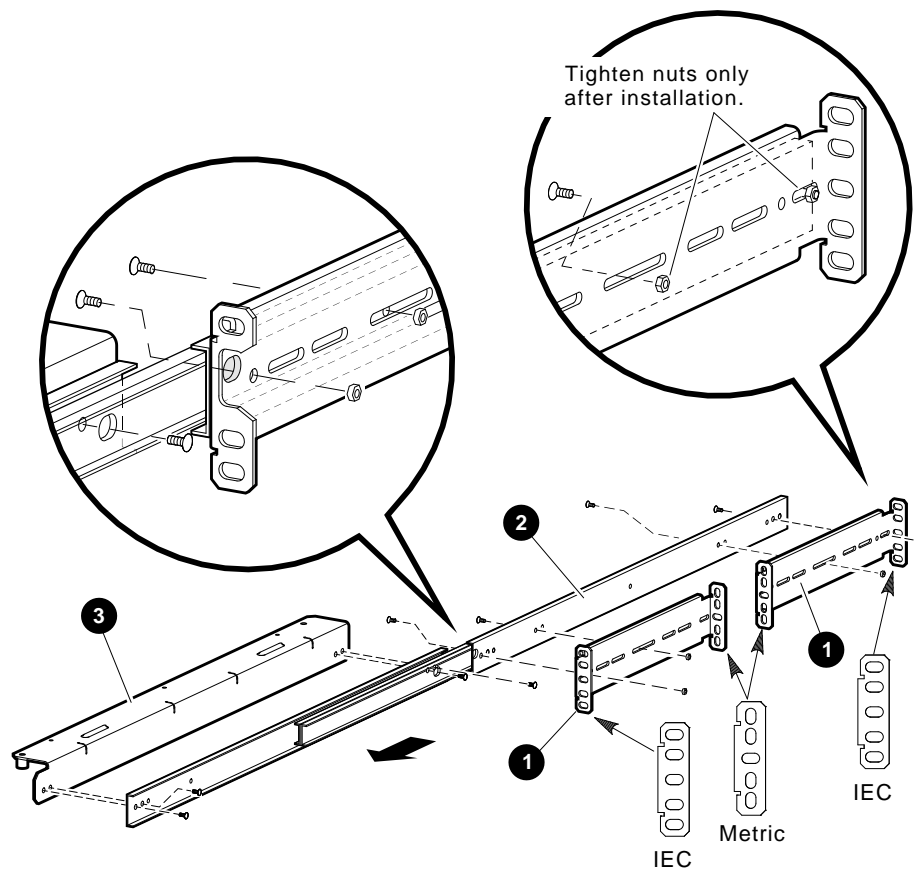

LJ-02537-T10

Continued on next page

Installation Procedure (H9A00-AJ Cabinet), Continued

Install the Right Side Chassis Slide Assembly

Required materials:

- Right side chassis slide assembly (assembled in the previous section)
- Two 10/32 screws

To install the right side chassis slide assembly, perform the following (Figure 2-5):

Step	Action
1	Count up 6 holes from the bottom of the installation area on the front and rear cabinet rails.
2	Count up 10 holes from the bottom of the installation area on the front and rear cabinet rails.
3	Align the chassis slide assembly ❶ to the sixth and tenth hole, then secure the assembly to the cabinet rails ❷.
4	Tighten the two screws at the rear slide mounting bracket.

Continued on next page

Installation Procedure (H9A00-AJ Cabinet), Continued

Figure 2-5 Installing the Right Side Chassis Slide Assembly

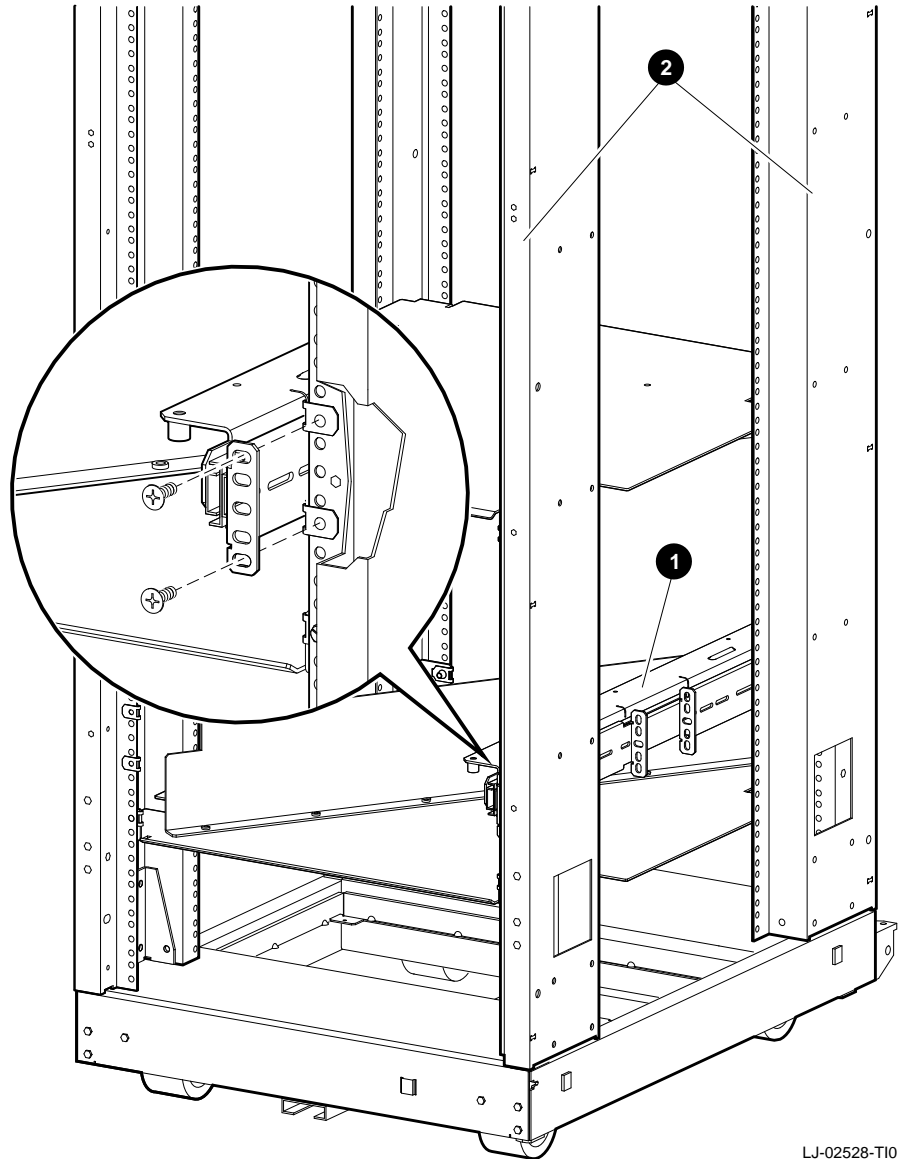

LJ-02528-T10

Continued on next page

Installation Procedure (H9A00-AJ Cabinet), Continued

Assemble the Left Side Chassis Slide Subassembly

Required materials:

- Eight 8/32 screws
- Eight nuts
- Two slide mounting brackets (PN 74-46197-01)
- Chassis slide (PN 12-18166-02)
- Slide mounting angle brace (PN 74-45548-01)

NOTE

The slide mounting brackets have two mounting ends. One end is for IEC mounting, and the other is for metric mounting. See Figure 2-6.

To assemble the left side chassis slide subassembly (Figure 2-6):

Steps	Action
1	Orient the slide mounting bracket ❶ so the IEC end is facing out.
2	Use four 8/32 screws to secure the slide mounting brackets to the chassis slide ❷. Do not tighten the two screws at the rear slide mounting bracket.
3	Use four 8/32 screws to secure the slide mounting angle brace ❸ to the chassis slide.

Continued on next page

Installation Procedure (H9A00-AJ Cabinet), Continued

Figure 2-6 Assembling of the Left Side Slide Subassembly

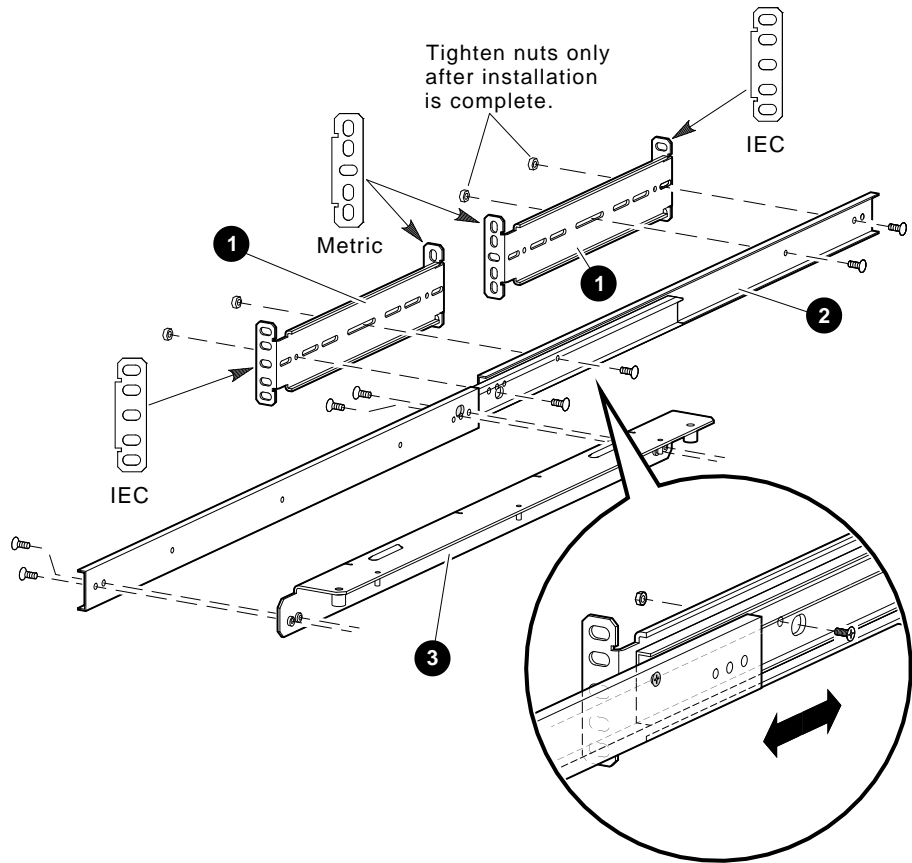

LJ-02538-T10

Continued on next page

Installation Procedure (H9A00-AJ Cabinet), Continued

Install the Left Side Chassis Slide Assembly

Required materials:

- Left side chassis slide assembly (assembled in the previous section)
- Two 10/32 screws

To install the left side chassis slide assembly (Figure 2-7):

Steps	Action
1	Count up 6 holes from the bottom of the installation area on the front and rear cabinet rails.
2	Count up 10 holes from the bottom of the installation area on the front and rear cabinet rails.
3	Align the chassis slide assembly ❶ to the sixth and tenth hole, then secure the assembly to the cabinet rails ❷.
4	Tighten the two screws at the rear slide mounting bracket.

Continued on next page

Installation Procedure (H9A00-AJ Cabinet), Continued

Figure 2-7 Installing the Left Side Chassis Slide Assembly

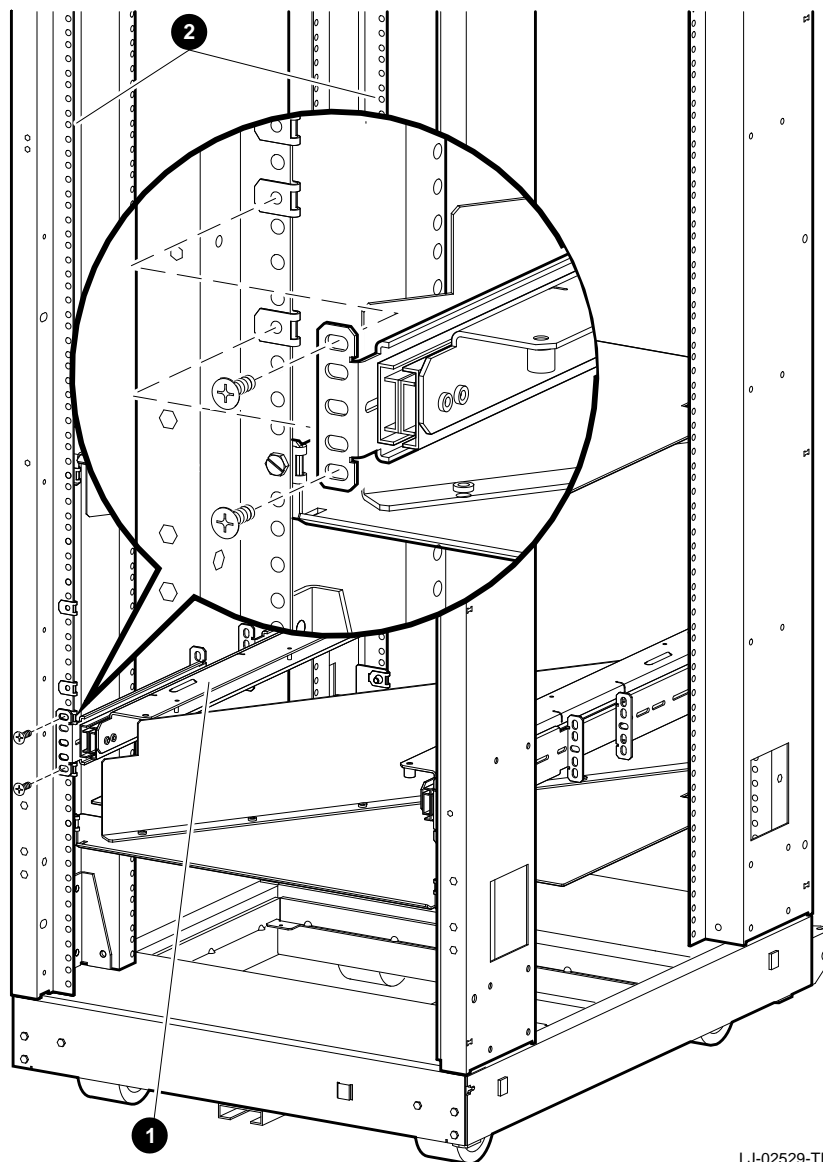

LJ-02529-T10

Continued on next page

Installation Procedure (H9A00-AJ Cabinet), Continued

Install Chassis Slide Support Brackets

Required materials:

- Three support brackets (PN 74-45547-01)
- Six nuts

To install the chassis slide support brackets (Figure 2-8):

Steps	Action
1	Slide out the stabilizer bar ❸ to support the weight of the system being installed (if not already out).
2	Fully extend both chassis slide assemblies ❶.
3	Use the six nuts to secure the three support brackets ❷ to the chassis slide assembly. Do not tighten the nuts.

Continued on next page

Installation Procedure (H9A00-AJ Cabinet), Continued

Figure 2-8 Installing the Chassis Slide Support Brackets

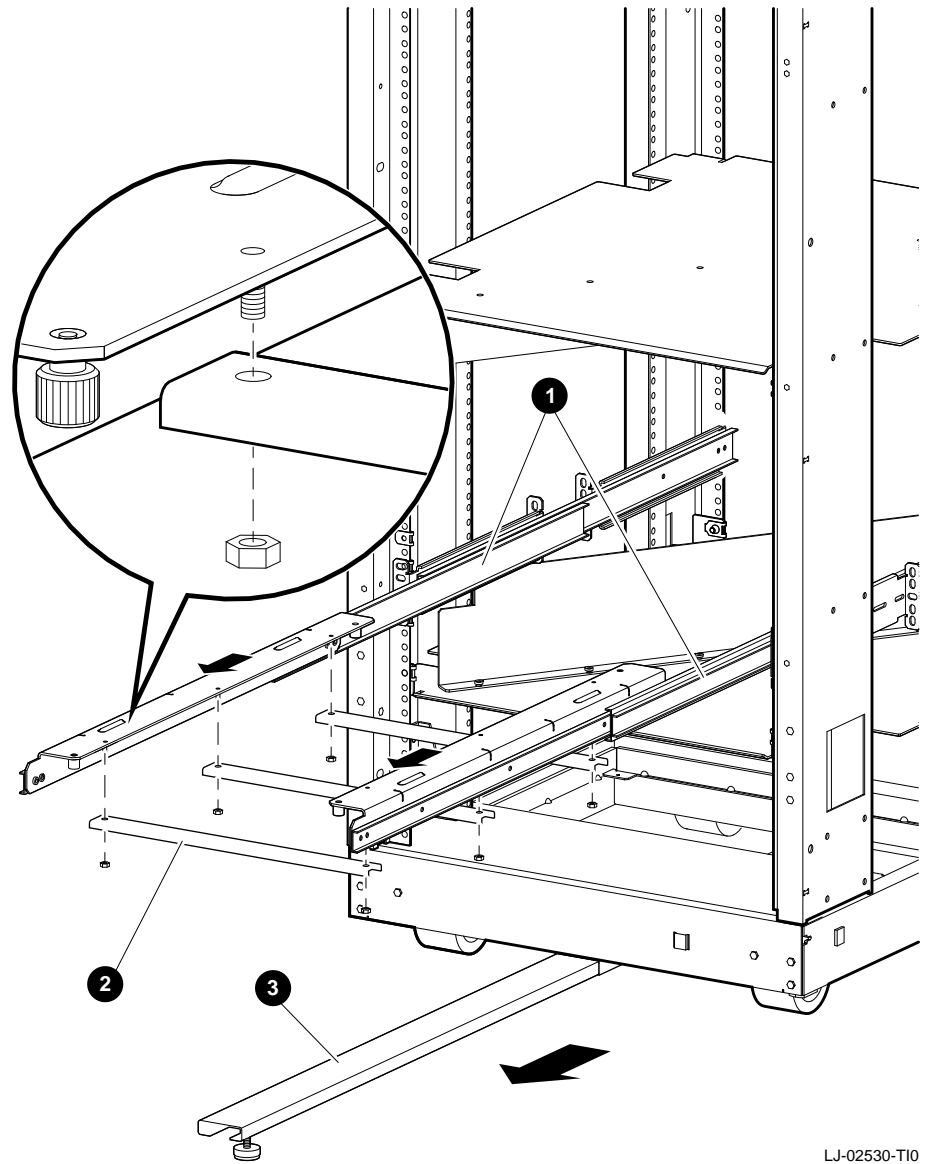

LJ-02530-T10

Continued on next page

Installation Procedure (H9A00-AJ Cabinet), Continued

Secure the
PE50A–B9/D9
Unit to the
Chassis Slide
Assembly

WARNING

Two people are required to install the system. Failure to do so could cause personal injury.

Digital does not recommend installing the PE50A–B9/D9 unit in the top area of the H9A00–AJ cabinet, for stability reasons.

To secure the PE50A-B9/D9 to the chassis slide assembly (Figure 2–9):

Steps	Action
1	Slide out the stabilizer bar (if not already out) to support the weight of the system being installed.
2	Slide out both chassis slide assemblies ② until they are fully extended.
3	Use two people to carefully lift the PE50A–B9/D9 unit ① and place it on the extended chassis slide assemblies ②.
4	Secure the PE50A–B9/D9 unit to the assemblies, using the four thumb screws at the bottom of the assemblies.
5	Tighten the six nuts securing the chassis slide support brackets to the assemblies.
6	Do not push the PE50A–B9/D9 unit into the cabinet.

Continued on next page

Installation Procedure (H9A00-AJ Cabinet), Continued

Figure 2-9 Securing the PE50A-B9/D9 Unit to the Chassis Slide Assembly

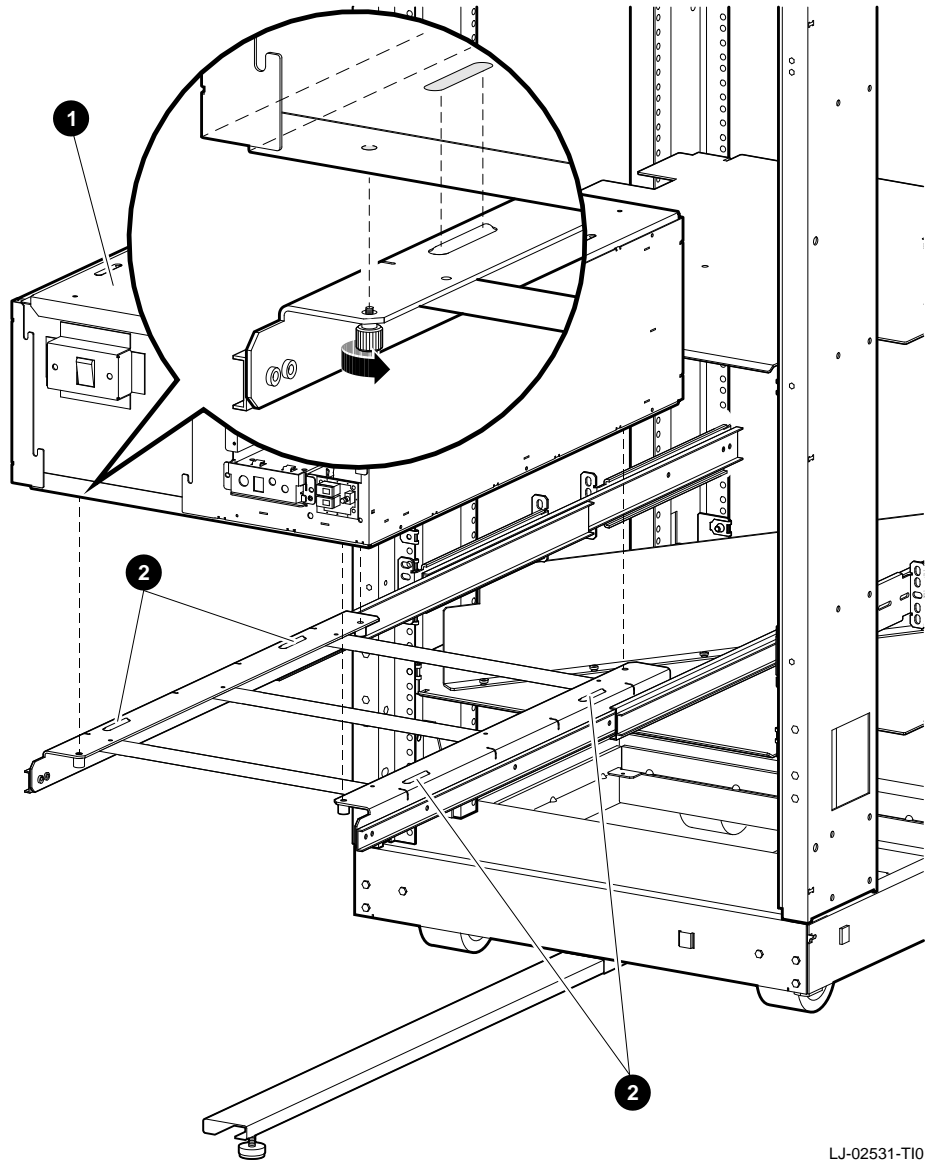

LJ-02531-T10

Continued on next page

Installation Procedure (H9A00-AJ Cabinet), Continued

Install the Faceplate Mounting Brackets

Required materials:

- Two 6/32 screws
- Four 10/32 screws
- Right mounting bracket (PN 74-45544-01)
- Left mounting bracket (PN 74-45543-01)

To install the faceplate mounting brackets (Figure 2-10):

Steps	Action
1	Use the two 6/32 screws to secure the right faceplate mounting brackets ❶ to the system❷. The left faceplate bracket is secured using the screws that are already in place on the power supply.
2	Count up 12 holes and 18 holes from the bottom of the installation area on the front cabinet rails.
3	Insert clip nuts at the locations determined in step 2 (if not already installed).
4	Push the PE50A-B9/D9 unit into the cabinet.
5	Use the four 10/32 screws to secure the faceplate mounting brackets ❶ to the cabinet.

Continued on next page

Installation Procedure (H9A00-AJ Cabinet), Continued

Figure 2-10 Installing the Faceplate Mounting Brackets

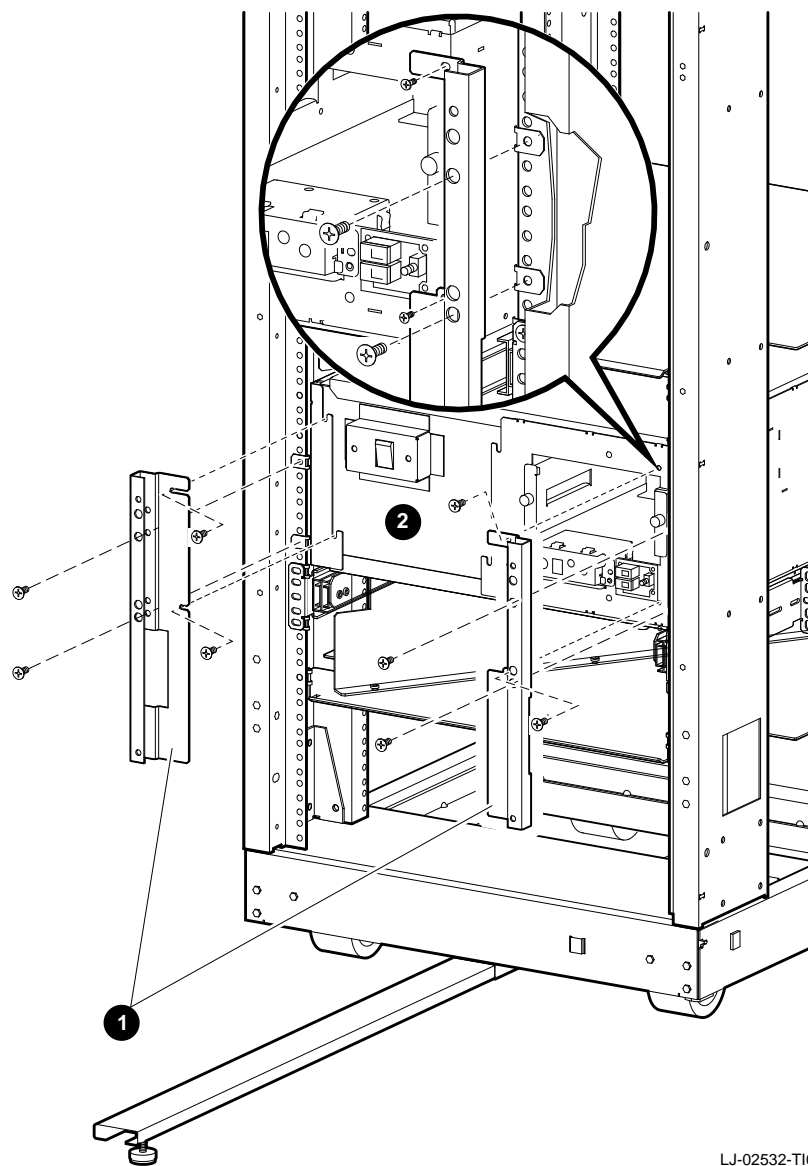

Continued on next page

Installation Procedure (H9A00-AJ Cabinet), Continued

Install the Faceplate

Required materials:

- Faceplate (PN 70-30304-01)
- Four 10/32 screws

To install the faceplate (Figure 2-11):

Step	Action
1	Align the face with the holes at the front of the cabinet.
2	Secure the faceplate to the front of the cabinet with the four 10/32 screws.

NOTE

In Figure 2-11, the faceplate has two option inserts. The bottom insert is for an RZ26 drive. The top insert is a blank, used when no other drive is installed with the RZ26.

Continued on next page

Installation Procedure (H9A00-AJ Cabinet), Continued

Figure 2-11 Installing the Faceplate

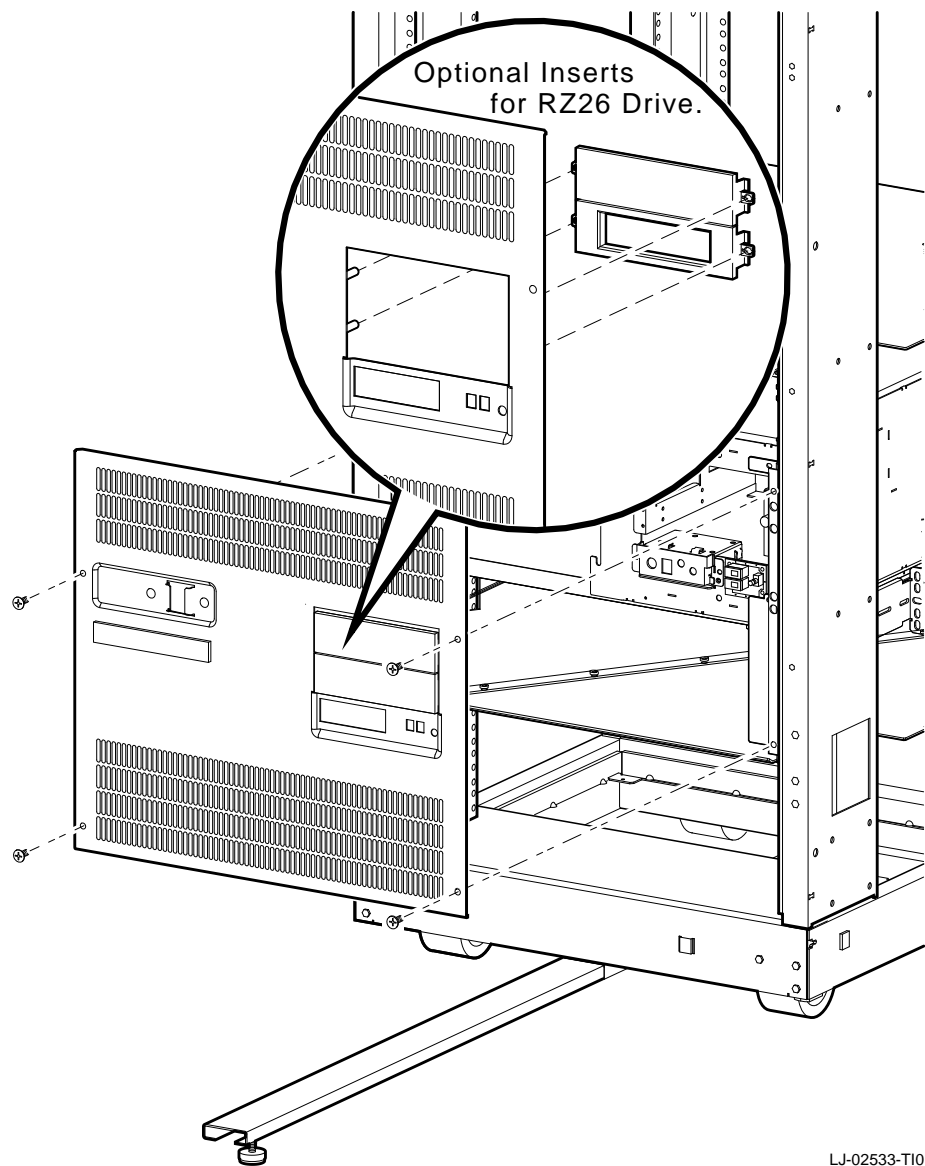

LJ-02533-T10

Continued on next page

Installation Procedure (H9A00-AJ Cabinet), Continued

Install the Rear Support Bracket

Required materials:

- Two 6/32 screws
- Rear support bracket (PN 74-45545-01)
- Four 10/32 screws

To install the rear support bracket (Figure 2-12):

Steps	Action
1	At the rear cabinet rails, count up 20 holes and 23 holes from the bottom of the installation area. Install clip nuts on these holes, if not already installed.
2	Use the two 6/32 screws to secure the rear support bracket ❶ to the rear of the PE50A-B9/D9 unit ❷.
3	Use the four 10/32 screws to secure the rear support bracket to the rear of the cabinet.

Continued on next page

Installation Procedure (H9A00-AJ Cabinet), Continued

Figure 2-12 Installing the Rear Support Bracket

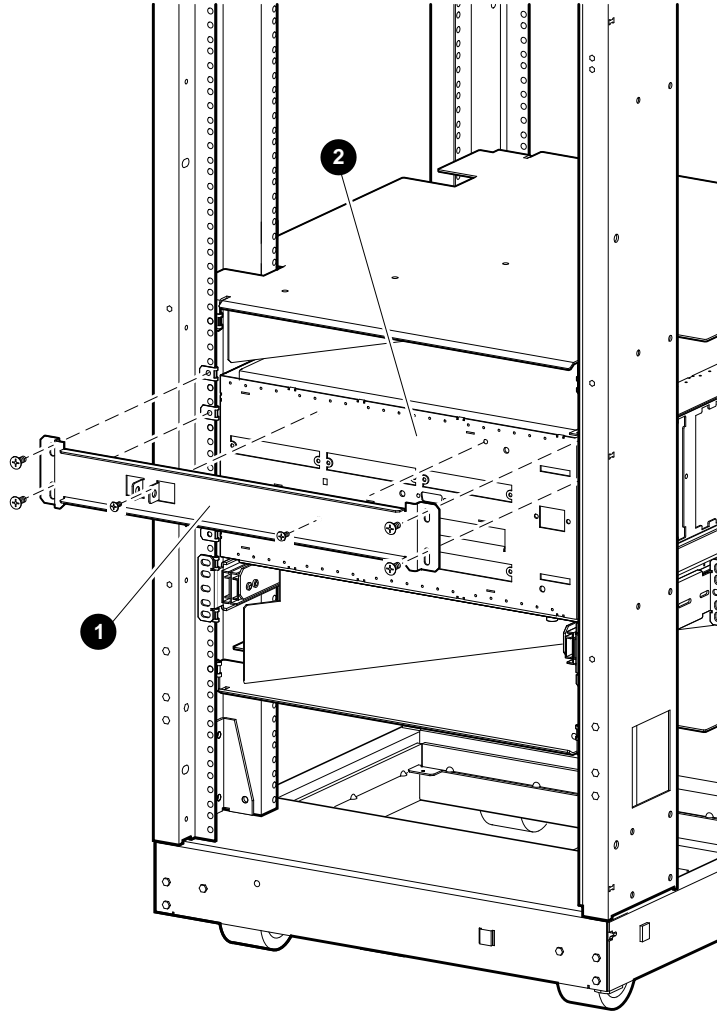

LJ-02534-T10

Continued on next page

Installation Procedure (H9A00-AJ Cabinet), Continued

Power and Cabling

Figure 2-13 shows the rear connectors, switches, and option slots on the DEC 3000 Model 500/500S AXP system. Table 2-1 describes these items.

Figure 2-14 shows the front switches, lights, jacks, and removable media slots. Table 2-2 describes these items.

To connect the system cables (Figure 2-13):

Steps	Action
1	Connect the keyboard/mouse cable ⑤.
2	Connect the monitor cable ⑩.
3	Connect power cord ⑫. There is no power controller
4	Connect any other necessary cables.

Continued on next page

Installation Procedure (H9A00-AJ Cabinet), Continued

Figure 2-13 Rear View of the System

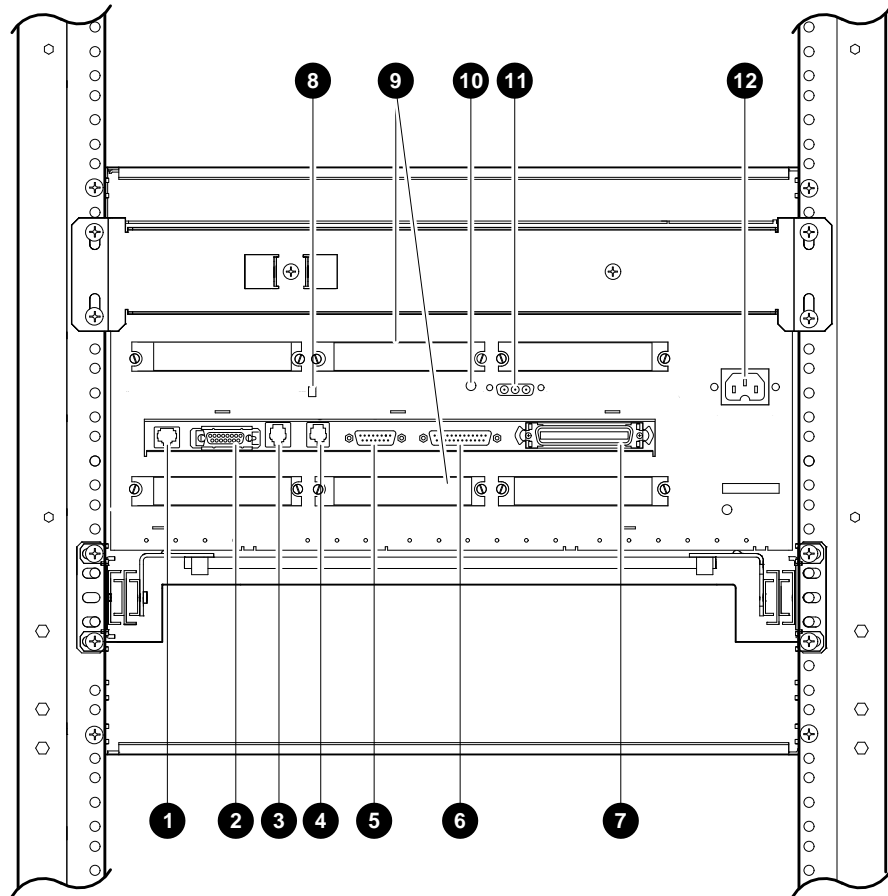

LJ-02442-T10

Continued on next page

Installation Procedure (H9A00-AJ Cabinet), Continued

Table 2-1 DEC 3000 Model 500/500S AXP System (Rear)

This Feature...	Lets You...
❶ 10baseT port	Connect a 10baseT (twisted-pair) Ethernet network cable.
❷ AUI Ethernet port	Connect an AUI (thickwire) Ethernet network cable.
❸ ISDN port	Connect an ISDN network cable.
❹ Printer/alternate console port	Connect a printer or an alternate console.
❺ Keyboard/mouse port	Connect the keyboard/mouse cable.
❻ Synch/asynch communications	Connect to a communication device, such as a modem.
❼ External SCSI port	Connect Small Computer System Interface (SCSI) peripheral devices.
❽ Printer/alternate console switch	Select the function of the printer /alternate console port.
❾ Six TURBOchannel slots	Install TURBOchannel option modules. (There are three designated slots for the I/O module and three slots for the system module.)
❿ Video refresh switch	Choose the correct video refresh rate (66Hz or 72Hz) for the monitor.
⓫ Monitor port	Connect the monitor video cable.
⓬ System power port	Connect the system power cord. (The port is keyed.)

Continued on next page

Installation Procedure (H9A00-AJ Cabinet), Continued

Figure 2-14 Front View of the System

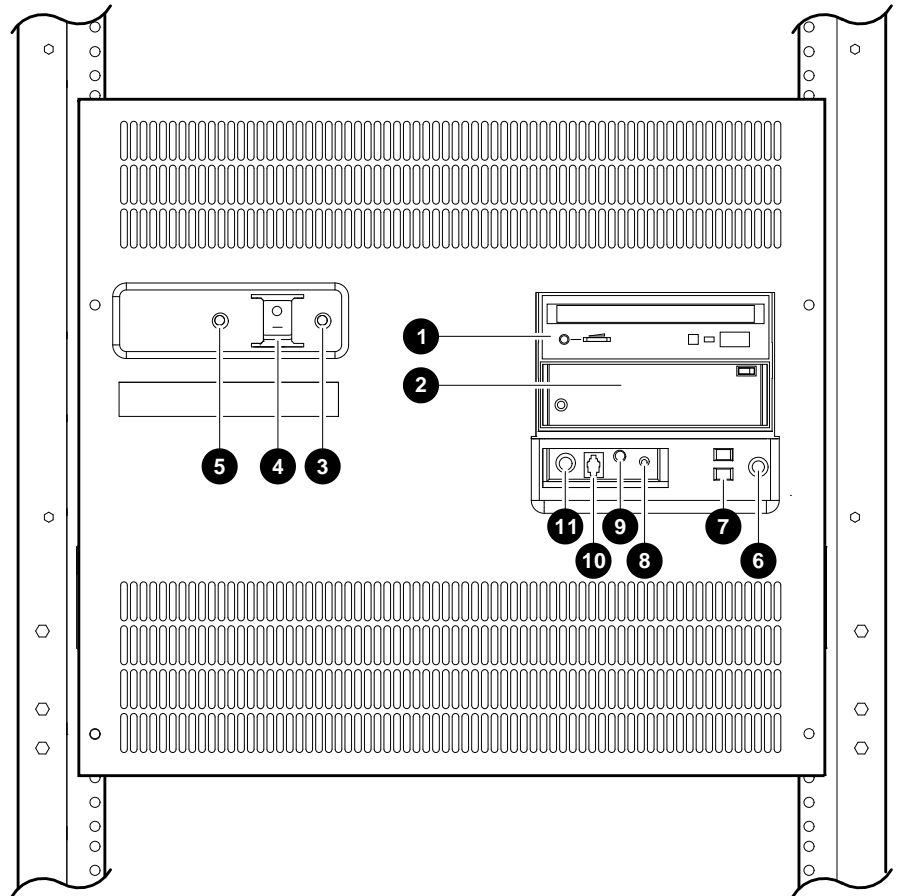

LJ-02535-T10

Continued on next page

Installation Procedure (H9A00-AJ Cabinet), Continued

Table 2-2 DEC 3000 Model 500/500S AXP System (Front)

This Feature...	Lets You...
❶ and ❷ Removable-media area	Access devices that use removable storage media such as diskettes, compact discs, cassette tapes, or cartridge tapes.
❸ DC OK light	Check that all dc voltages are present on the power supply.
❹ On/Off switch	Turn the system on and off (0).
❺ Fan indicator light	Check whether a fan has failed.
❻ Halt button	Put the system in console mode.
❼ Diagnostic display	View error codes that may indicate potential problems with the system.
❽ Microphone input jack	Connect a microphone to the system.
❾ Speaker output jack	Connect a speaker or headphone for audio output.
❿ Telephone jack	Connect a telephone handset.
⓫ Audio input jack	Connect an audio input line.

Verify the System

For system verification, refer to *DEC 3000 Model 500/500S AXP Service Information*.
