

AlphaServer 1000A Series
Illustrated Parts Breakdown

Order Number: EK-ALPSV-IP. B01

Digital Equipment Corporation
Maynard, Massachusetts

Digital Equipment Corporation reserves the right, without notice, to make substitutions and modifications in the specifications of products documented in this manual and further reserves the right to withdraw any of these products from the market without notice.

Digital Equipment Corporation is not responsible for errors which may appear in the technical description (including illustrations and photographs) of the products covered by this manual.

None of the descriptions contained in this manual imply the granting of any license whatsoever to make, use or sell equipment constructed in accordance therewith.

Restricted Rights: Use, duplication or disclosure by the U.S. Government is subject to restrictions as set forth in subparagraph (c) (1) (ii) of the Rights in Technical Data and Computer Software clause at DFARS 252.227-2713.

Copyright © 1996 by Digital Equipment Corporation. All rights reserved.
Printed in U.S.A.

The following are trademarks of Digital Equipment Corporation :
AXP, DEC, Digital UNIX, Open VMS, StorageWorks, the AXP logo and the Digital logo.

The following are third party trademarks:
Windows NT is a registered trademark of Microsoft Corporation.

Reader's Comments

Digital welcomes your comments on this or any other manual.
You can send your comments to Digital in the following ways:

- Internet electronic mail to: *readers_comment@zk3.dec.com*
- Mail:

Digital Equipment Corporation
Shared Engineering Services
129 Parker Street
PKO3-2/21J
Maynard, MA 01754-2199

Please reference EK-ALPSV-IP. B01 in your correspondence.

**ILLUSTRATED
PARTS
BREAKDOWN**

AlphaServer 1000A Series

ILLUSTRATED PARTS BREAKDOWN (IPB)

The IPB is used to identify a part and its location in a hardware product. The document references specific item numbers in the associated parts list.

HOW TO USE THE IPB

1. Locate the figure containing the item of interest.
2. Locate the number (callout) of the item of interest.
3. Locate that item number in the associated parts list.

FORMAT

Each IPB is generally organized based on its first figure. All other assemblies and subassemblies are referenced from this figure. Each figure contains numeric callouts of all major parts (items).

PARTS LIST

Each parts list contains the following:

Figure and Item No. – Lists the figure number and its referenced numeric callout

Description – Presents the name and a brief description of the item. A single asterisk (*) preceding the description denotes item is a

subassembly to its referenced figure. A double asterisk (**) preceding the description indicates that this item is subordinate to the preceding single asterisk item.

Digital Part No. – Lists the Digital/Vendor part number. The letter in the column heading indicates the current revision level of the Engineering Drawing for the referenced figure.

ECO Cut-In – Lists the top assembly drawing number and revision level at first printing. All additional revisions to an item are listed in this column.

Used On Code – Lists letters referring to the product variation assigned in Figure 1. When this column is blank, the item is used in all variations.

Ref Fig No. – Lists a cross reference between figures within the IPB.

PART NUMBER/PART DESCRIPTION INDEX SECTION

Lists items by part number numerically, and description alphabetically. Items are also referenced to a location within the IPB by figure and item number.

ECO/REVISION HISTORY

**OTHER IPB
MANUALS
REFERENCED**

FIGURE NO.	ASSEMBLY	INITIAL LEVEL	CURRENT LEVEL	PRINTING DATE	OTHER IPB MANUALS REFERENCED
1	PB73A	00001	00002	30-AUG-96	N/A
1	PB74A	00001	00002		
1	PB76A	00000	00000		
1	PB77A	00000	00000		
1	PB78A	00000	00000		
2	30-41899	00001	00004		

  INDICATES FRU LEVEL PARTS.

PARTS LIST 

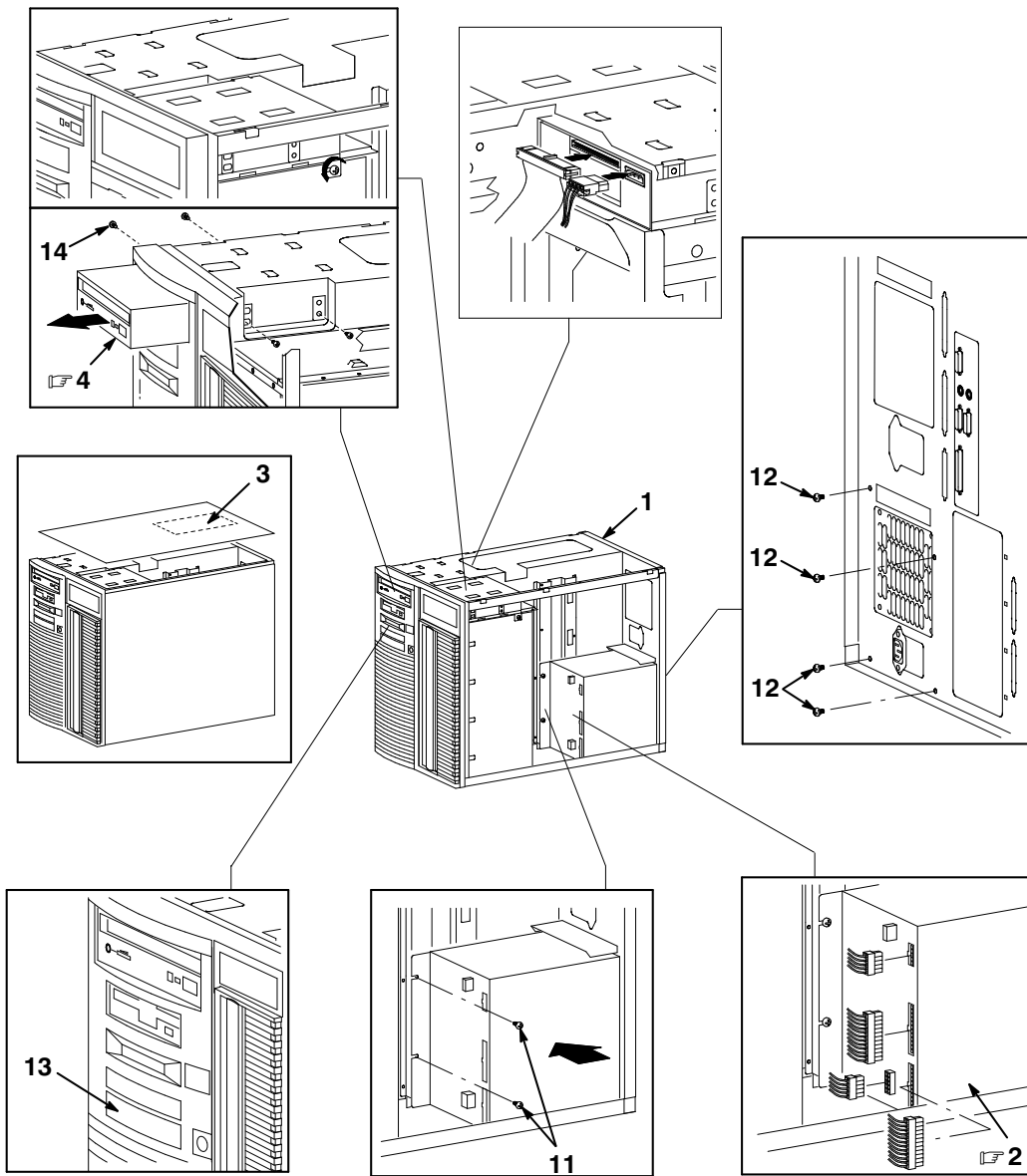

IP-PB73A-01

Figure 1. Kernel Assemblies (Sheet 1 of 3)

INDICATES FRU LEVEL PARTS.

PARTS LIST

APPLIES TO PB76A, PB77A, PB78A

APPLIES TO PB73A and PB74A

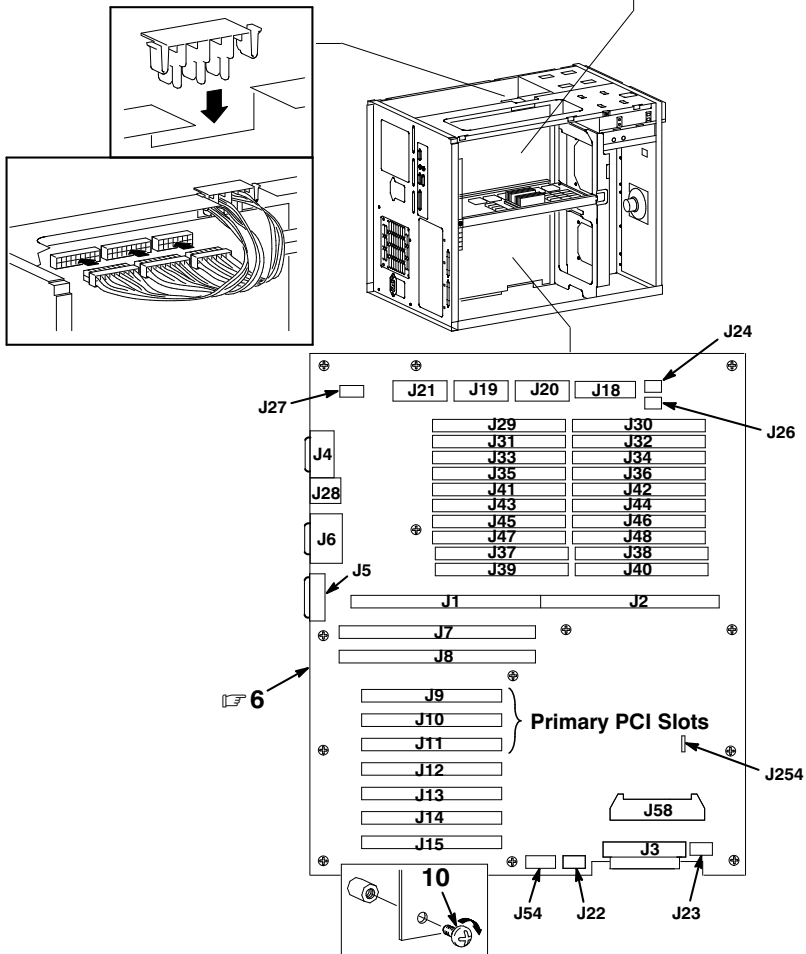
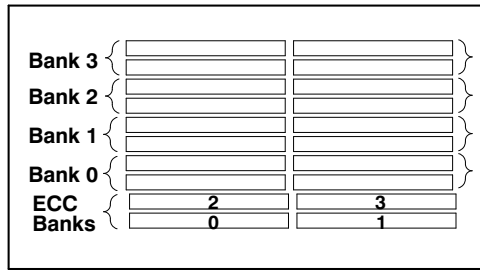
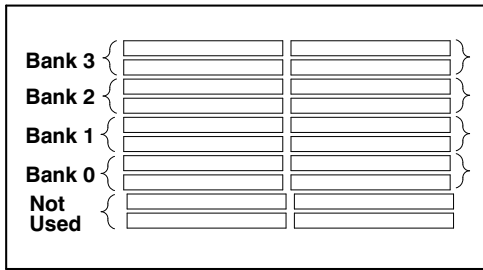

IP-PB73A-02

Figure 1. Kernel Assemblies (Sheet 2 of 3)

 INDICATES FRU LEVEL PARTS.

PARTS LIST 

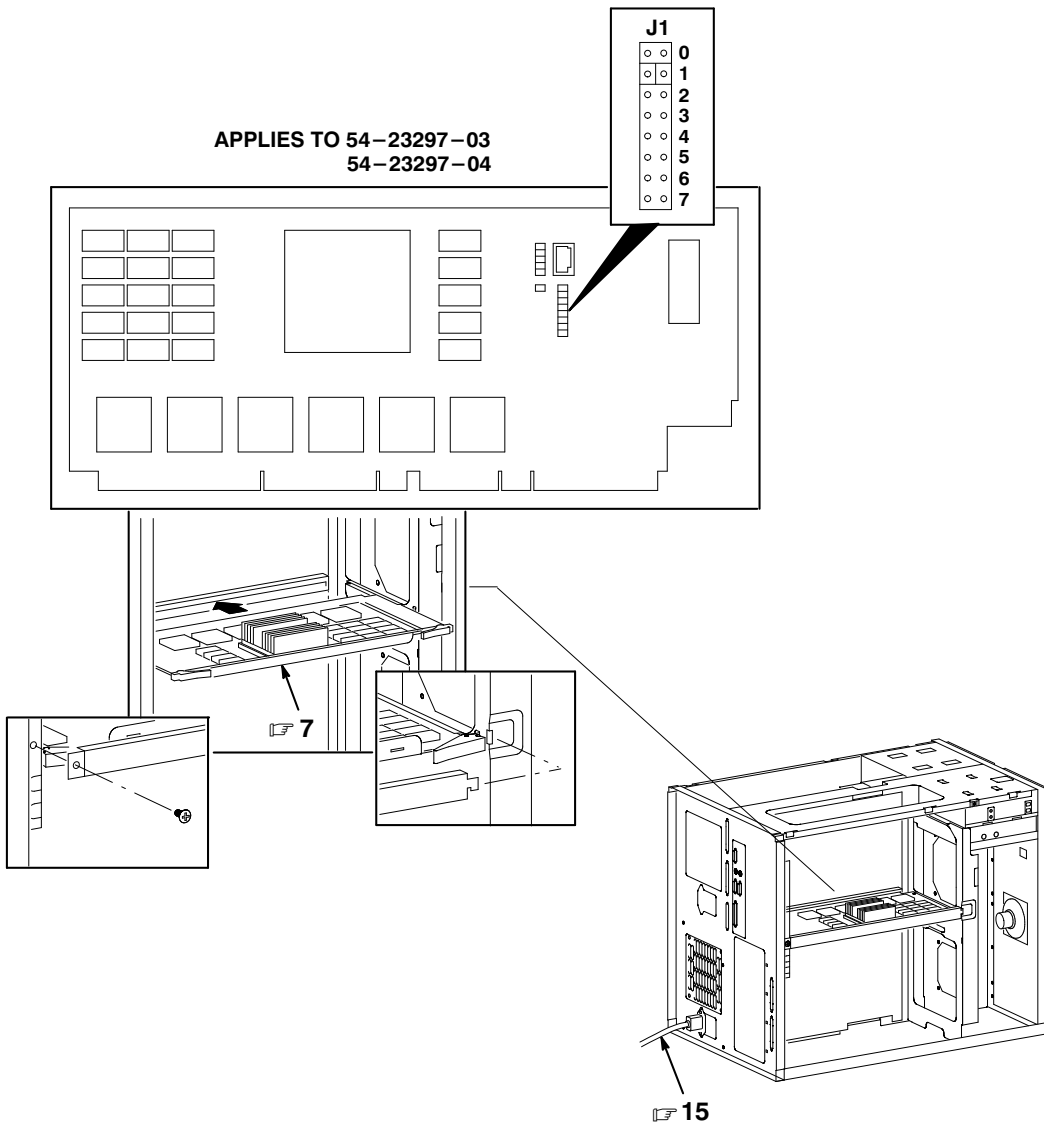

IP-PB73A-03

Figure 1. Kernel Assemblies (Sheet 3 of 3)

FIG. & ITEM NO.	DESCRIPTION	DIGITAL PART NO.	ECO CUT-IN	USED ON CODE	REF FIG NO.
1-	KERNEL ASSEMBLIES				
A	AlphaServer 1000A MODEL 4/233	PB73A-A9		A	
B	AlphaServer 1000A MODEL 4/266	PB74A-A9		B	
C	AlphaServer 1000A MODEL 5/300	PB77A-A9		C	
D	AlphaServer 1000A MODEL 5/333	PB76A-A9		D	
E	AlphaServer 1000A MODEL 5/400	PB78A-A9		E	
1	*DESKSIDE TOWER (360 MM Width, 440 MM Height, 530 MM Depth)	30-41899-02			2
2	*Power Supply, 450W	30-43120-02			
3	*Label, "Customer Installation"	36-43629-02			
4	*CD-ROM (4X)	RRD45-AA			
5	*Adapter, DECstation 2000, 9-Pin Serial (Not Shown)	H8571-J			
6	*Module, Main Logic Board (MLB) (Video)	54-23499-01		ABC	
6	*Module, Main Logic Board (MLB) (No Video)	54-23499-02		DE	
7	*Module, Alpha Processor, 233 MHz, EV45	54-23297-03		A	
7	*Module, Alpha Processor, 266 MHz, EV45	54-23297-04		B	
7	*Module, Alpha Processor, 300 MHz, EV5	54-24719-02		C	
7	*Module, Alpha Processor, 333 MHz, EV56	54-24799-02		D	
7	*Module, Alpha Processor, 400 MHz, EV56	54-24799-01		E	
8	*Package Assembly (Not Shown)	37-01507-01			
9	*Kit, EISA System Configuration (Not Shown)	QC-01YAA-HC			
10	*Screw, Sems M 3.0 Pan 6 mm	90-09984-20			
11	*Screw, Sems M 3.5 Pan 8 mm	90-09984-29			
12	*Screw, Sems Pan Hd No. 6-32 x 1/4	90-00049-01			
13	*Medallion, AlphaServer 1000A 4/233	74-49172-06		A	
13	*Medallion, AlphaServer 1000A 4/266	74-49172-05		B	
13	*Medallion, AlphaServer 1000A 5/300	74-49172-08		C	
13	*Medallion, AlphaServer 1000A 5/333	74-49172-09		D	
13	*Medallion, AlphaServer 1000A 5/400	74-49172-10		E	
14	*Screw, Mach M3 Pan 6mm	90-10961-02			
15	*Power Cord (U.S., Japan, Canada) (BN26J-1K)	17-00083-09			
15	*Power Cord (Australia, New Zealand) (BN19H-2E)	17-00198-14			
15	*Power Cord (Austria, Belgium, France, Germany, Finland, Holland, Norway, Sweden, Portugal, Spain) (BN19C-2E)	17-00199-21			
15	*Power Cord (U.K., Ireland) (BN19A-2E)	17-00210-15			
15	*Power Cord (Switzerland) (BN19E-2E)	17-00210-13			
15	*Power Cord (Denmark) (BN19K-2E)	17-00310-08			
15	*Power Cord (Italy) (BN19M-2E)	17-00364-18			
15	*Power Cord (India, South Africa, Egypt) (BN19S-2E)	17-00456-16			
15	*Power Cord (Israel) (BN18L-2E)	17-00457-16			

FIG. & ITEM NO.	DESCRIPTION	DIGITAL PART NO.	ECO CUT-IN	USED ON CODE	REF FIG NO.
1-	KERNEL ASSEMBLIES (continued)				
16	Documentation (Not Shown) "Owner's Guide" "Owner's Guide Supplement (EV5)" "Service Guide"	EK-ALPSV-OG EK-AL530-OG EK-ALPSV-SV		CDE	

INDICATES FRU LEVEL PARTS.

PARTS LIST

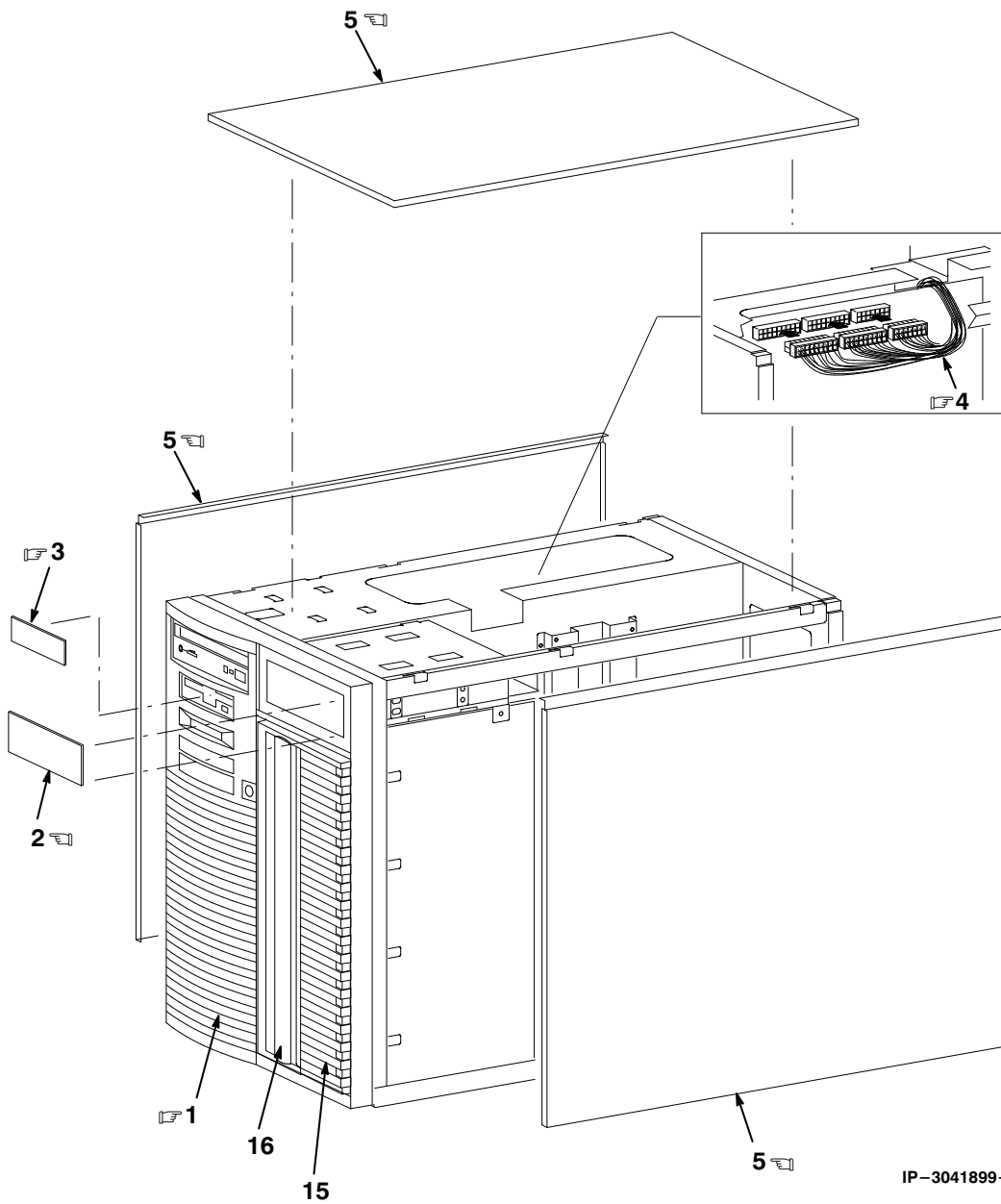

IP-3041899-01

Figure 2. Deskside Tower (Sheet 1 of 6)

  INDICATES FRU LEVEL PARTS.

PARTS LIST 

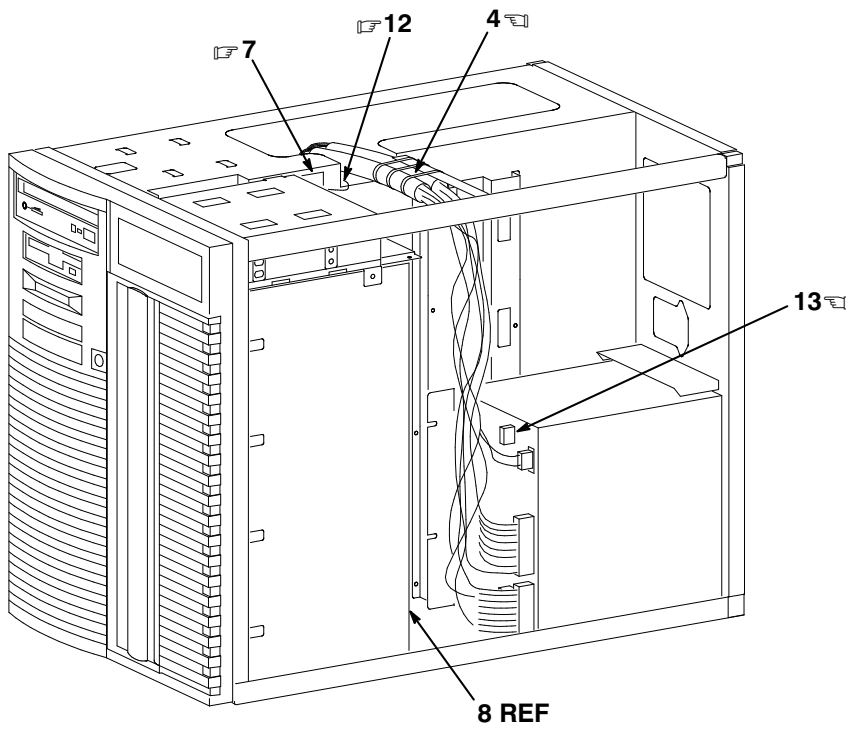

IP-3041899-02

Figure 2. Desktower (Sheet 2 of 6)

INDICATES FRU LEVEL PARTS.

PARTS LIST

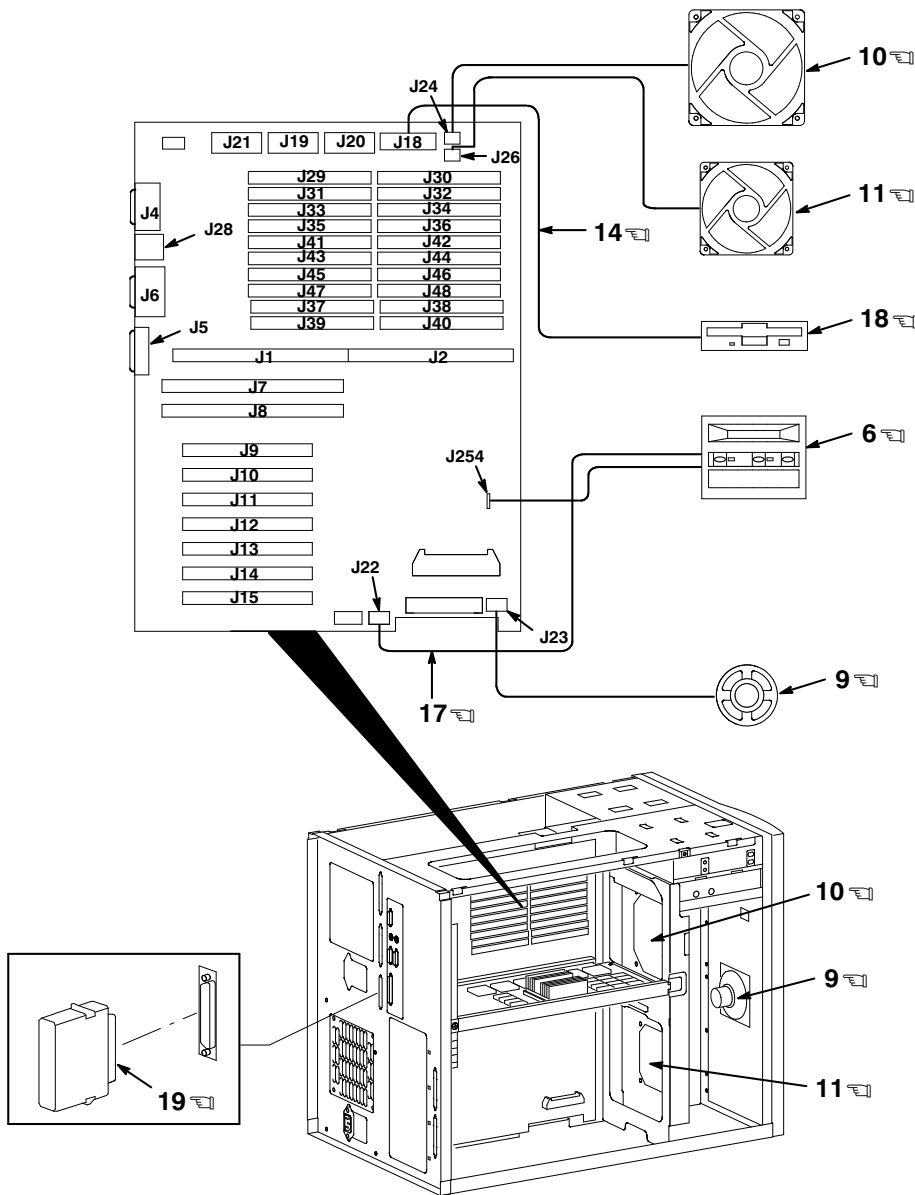

IP-3041899-03

Figure 2. Desktop Tower (Sheet 3 of 6)

INDICATES FRU LEVEL PARTS.

PARTS LIST

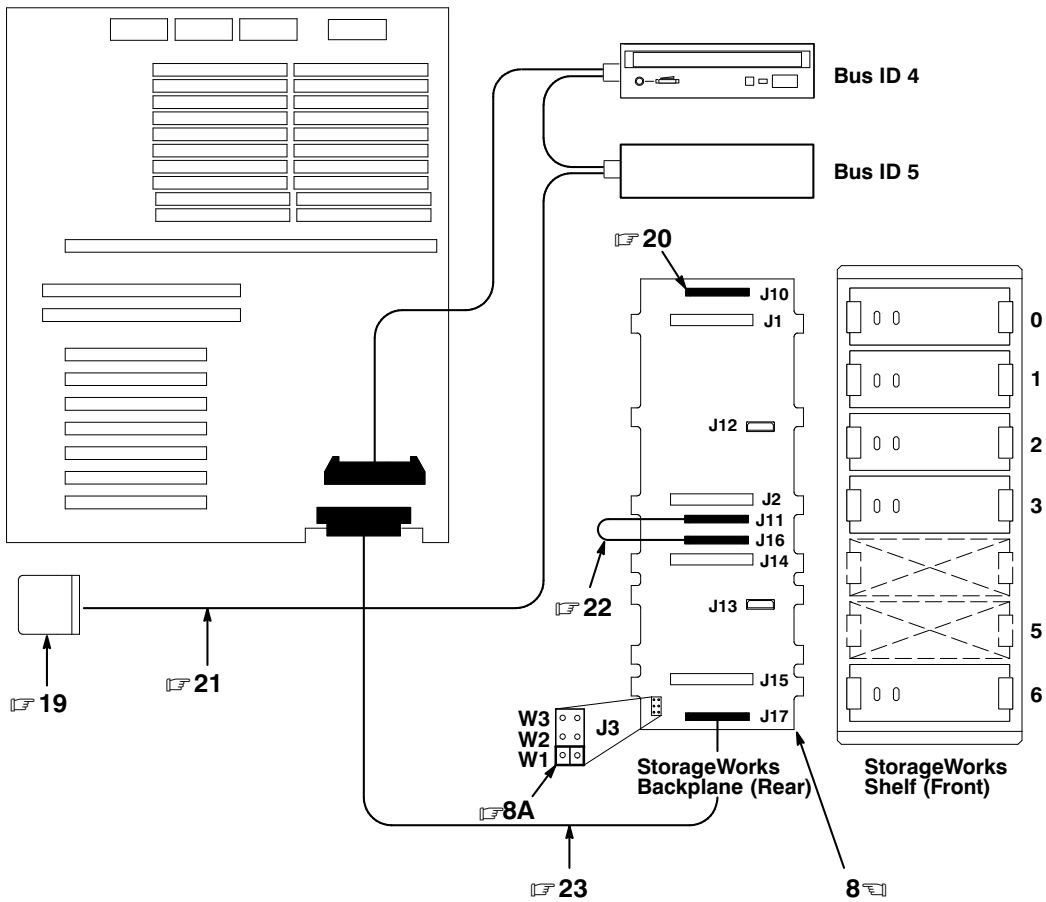

SINGLE-CONTROLLER SCSI CONFIGURATION

IP-3041899-04

Figure 2. Deskside Tower (Sheet 4 of 6)

INDICATES FRU LEVEL PARTS.

PARTS LIST

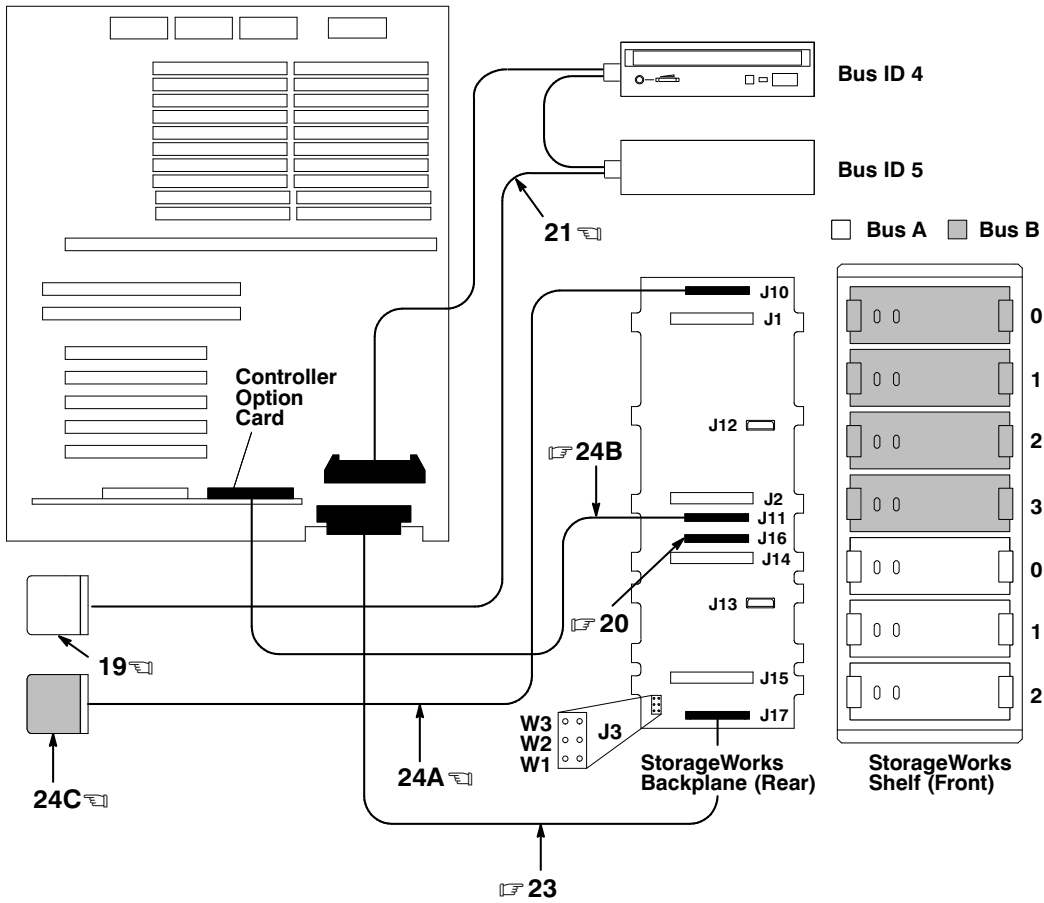

DUAL-CONTROLLER SCSI CONFIGURATION with SPLIT StorageWorks BACKPLANE

IP-3041899-05

Figure 2. Deskside Tower (Sheet 5 of 6)

INDICATES FRU LEVEL PARTS.

PARTS LIST

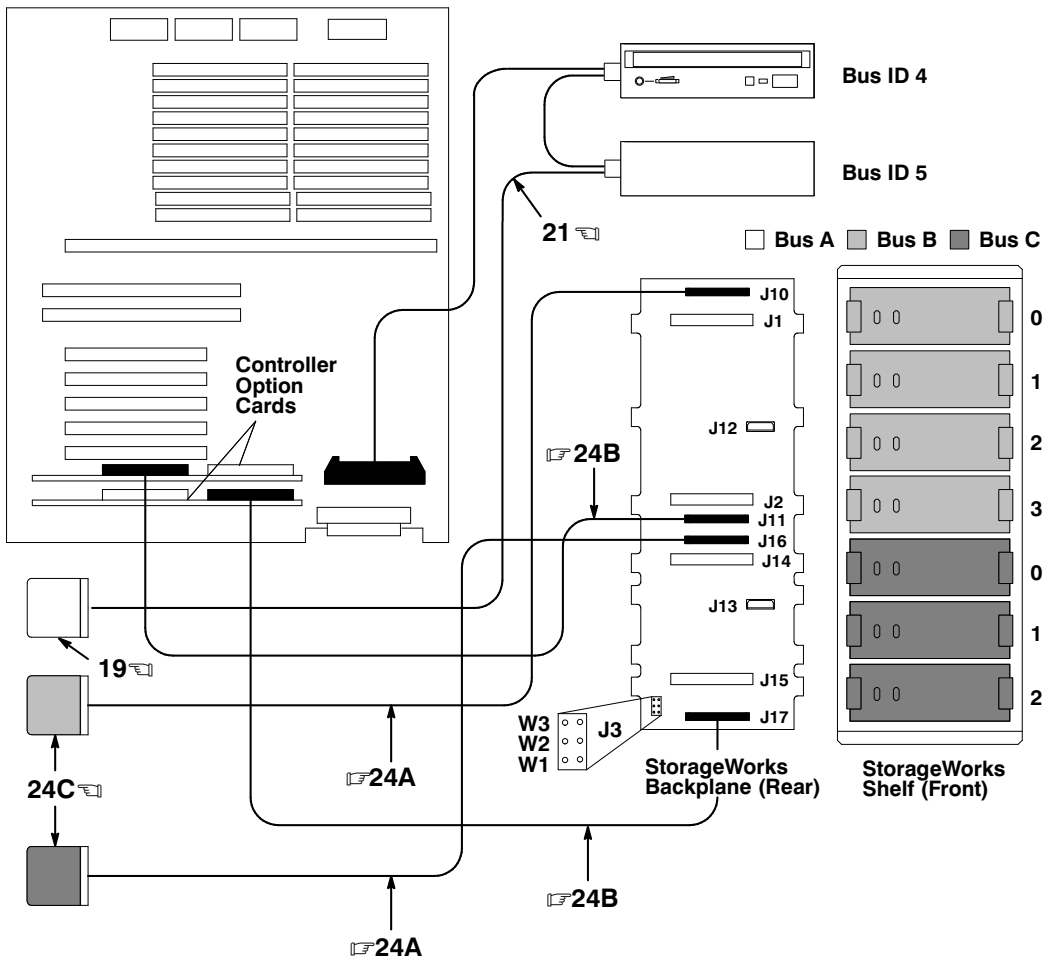

TRIPLE-CONTROLLER SCSI CONFIGURATION with SPLIT StorageWorks BACKPLANE

IP-3041899-06

Figure 2. Deskside Tower (Sheet 6 of 6)

FIG. & ITEM NO.	DESCRIPTION	D DIGITAL PART NO.	ECO CUT-IN 3041899 00001	USED ON CODE	REF FIG NO.
2- A	DESKSIDE TOWER (360 MM Width, 440 MM Height, 530 MM Depth)	30-41899-02			1
☞ 1	*Panel Assembly, Front	70-31345-01			
☞ 2	*Cover, 5 1/4 Inch Panel	74-49537-01			
☞ 3	*Cover, 3 1/4 Inch Panel	74-49538-01			
☞ 4	*CABLE ASSEMBLY, DC POWER SUPPLY	70-31346-01			
	**Harness, Power Supply Signal/Misc. (15-Pin)	17-03965-01			
	**Harness, Power Supply +5V (24-Pin)	17-03966-01			
	**Harness, Power Supply +3.3V (20-Pin)	17-03968-01			
	**Harness, Power Supply Storage (12-Pin)	17-03969-01			
☞ 5	*Cover Assembly	70-31347-01			
☞ 6	*Module, OCP	54-23302-01			
☞ 7	*Interlock Switch Assembly	70-31348-01			
☞ 8	*Backplane Assembly, StorageWorks	54-23365-01			
☞ 8A	**Jumper, StorageWorks, Split UNIBUS	12-14314-00			
☞ 9	*Speaker Assembly	70-31349-01			
☞ 10	*Fan Assembly (120 mm)	70-31351-01			
☞ 11	*Fan Assembly (92 mm)	70-31350-01			
☞ 12	*Cable, Interlock/Server Management (2-Pin)	70-32283-01			
☞ 13	Cable, Power Supply Current Sharing (3-Pin)	17-04195-01			
☞ 14	*Cable, Floppy Drive (34-Pin)	17-03970-02			
☞ 15	*Door, AlphaServer 1000A	74-50847-01			
☞ 16	*Lens, Snap-In	74-50848-01			
☞ 17	*Cable, OCP Module (10-Pin)	17-03971-01			
☞ 18	*Floppy Drive, (3 1/2 Inch) 1.44 MB	RX23L-AA			
☞ 19	Terminator, 50 Pin SCSI, External	12-41667-05			
☞ 20	Terminator, 68 Pin SCSI, Active, Internal	12-45490-01			
	SINGLE-CONTROLLER SCSI CONFIGURATION (See Page 9)				
☞ 21	*Cable, SCSI, 50 Cond. Daisychain, (MLB to Removable Media Devices to External Port)	17-04233-01			
☞ 22	*Cable, Internal StorageWorks Jumper (68-Pin)	17-04021-01			
☞ 23	*Cable, SCSI, 68 Cond. (MLB to StorageWorks)	17-04022-02			
	DUAL-CONTROLLER SCSI CONFIGURATION w/ SPLIT StorageWorks BACKPLANE (See Page 10)				
☞ 21	*Cable, SCSI, 50 Cond. Daisychain, (MLB to Removable Media Devices to External Port)	17-04233-01			
☞ 23	*Cable, SCSI, 68 Cond. (MLB to StorageWorks)	17-04022-02			
☞ 24	CABLE KIT, 16-Bit (Wide) SCSI	PB7HA-BA			
☞ 24A	*Cable, SCSI, 68 Cond. (StorageWorks to External Port)	17-04019-01			
☞ 24B	*Cable, SCSI, 68 Cond. (Option Controller to StorageWorks)	17-04022-01			
☞ 24C	*Terminator, 68 Pin SCSI, External	12-41768-03			

FIG. & ITEM NO.	DESCRIPTION	DIGITAL PART NO. ^D	ECO CUT-IN 3041899 00001	USED ON CODE	REF FIG NO.
2- A	DESKSIDE TOWER (continued)				
	TRIPLE-CONTROLLER SCSI CONFIGURATION w/ SPLIT StorageWorks BACKPLANE (See Page 11)				
☞ 21	*Cable, SCSI, 50 Cond. Daisychain, (MLB to Removable Media Devices to External Port)	17-04233-01			
☞ 24	CABLE KIT, 16-Bit (Wide) SCSI	PB7HA-BA			
☞ 24A	**Cable, SCSI, 68 Cond. (StorageWorks to External Port)	17-04019-01			
☞ 24B	**Cable, SCSI, 68 Cond. (Option Controller to StorageWorks)	17-04022-01			
☞ 24C	**Terminator, 68 Pin SCSI, External	12-41768-03			
25	ADDITIONAL FRUs (Not Shown)				
☞	Chip, NVRAM (E14)	21-29631-02			
☞	Chip, NVRAM TOY Clock (E78)	21-32423-01			
☞	Key, Door	74-50062-01			

PART NUMBER/DESCRIPTION INDEX 

INDEX BY DIGITAL PART NUMBER

AlphaServer 1000A Series

PART NUMBER	DESCRIPTION	FIG.-ITEM NUMBER
12-14314-00	Jumper, StorageWorks, Split UNIBUS	2-8A
12-41667-05	Terminator, 50 Pin SCSI, External	2-19
12-41768-03	Terminator, 68 Pin SCSI, External	2-24C
12-45490-01	Terminator, 68 Pin SCSI, Active, Internal	2-20
17-00083-09	Power Cord (U.S., Japan, Canada) (BN26J-1K)	1-15
17-00198-14	Power Cord (Australia, New Zealand) (BN19H-2E)	1-15
17-00199-21	Power Cord (Austria, Belgium, France, Germany, Finland, Holland, Norway, Sweden, Portugal, Spain) (BN19C-2E)	1-15
17-00210-13	Power Cord (Switzerland) (BN19E-2E)	1-15
17-00210-15	Power Cord (U.K., Ireland) (BN19A-2E)	1-15
17-00310-08	Power Cord (Denmark) (BN19K-2E)	1-15
17-00364-18	Power Cord (Italy) (BN19M-2E)	1-15
17-00456-16	Power Cord (India, South Africa, Egypt) (BN19S-2E)	1-15
17-00457-16	Power Cord (Israel) (BN18L-2E)	1-15
17-03965-01	Harness, Power Supply Signal/Misc. (15-Pin)	2-4
17-03966-01	Harness, Power Supply +5V (24-Pin)	2-4
17-03968-01	Harness, Power Supply +3.3V (20-Pin)	2-4
17-03969-01	Harness, Power Supply Storage (12-Pin)	2-4
17-03970-02	Cable, Floppy Drive (34-Pin)	2-14
17-03971-01	Cable, OCP Module (10-Pin)	2-17
17-04019-01	Cable, SCSI, 68 Cond. (StorageWorks to External Port)	2-24A
17-04021-01	Cable, Internal StorageWorks Jumper (68-Pin)	2-22
17-04022-01	Cable, SCSI, 68 Cond. (Option Controller to StorageWorks)	2-24B
17-04022-02	Cable, SCSI, 68 Cond. (MLB to StorageWorks)	2-23
17-04195-01	Cable, Power Supply Current Sharing (3-Pin)	2-13
17-04233-01	Cable, SCSI, 50 Cond. Daisychain, (MLB to Removable Media Devices to External Port)	2-21
21-29631-02	Chip, NVRAM (E14) (Not Shown)	2-25
21-32423-01	Chip, NVRAM TOY Clock (E78) (Not Shown)	2-25
30-41899-02	DEKSIDESIDE TOWER (360 MM Width, 440 MM Height, 530 MM Depth)	1-1, 2-A
30-43120-02	Power Supply, 450W	1-2
36-43629-02	Label, "Customer Installation"	1-3
37-01507-01	Package Assembly (Not Shown)	1-8
54-23297-03	Module, Alpha Processor, 233 MHz, EV45	1-7
54-23297-04	Module, Alpha Processor, 266 MHz, EV45	1-7
54-23302-01	Module, OCP	2-6
54-23365-01	Backplane Assembly, StorageWorks	2-8
54-23499-01	Module, Main Logic Board (MLB) (Video)	1-6
54-23499-02	Module, Main Logic Board (MLB) (No Video)	1-6
54-24719-02	Module, Alpha Processor, 300 MHz, EV5	1-7
54-24799-01	Module, Alpha Processor, 400 MHz, EV56	1-7
54-24799-02	Module, Alpha Processor, 333 MHz, EV56	1-7

INDEX BY DIGITAL PART NUMBER

AlphaServer 1000A Series

PART NUMBER	DESCRIPTION	FIG.-ITEM NUMBER
70-31345-01	Panel Assembly, Front	2-1
70-31346-01	CABLE ASSEMBLY, DC POWER SUPPLY	2-4
70-31347-01	Cover Assembly	2-5
70-31348-01	Interlock Switch Assembly	2-7
70-31349-01	Speaker Assembly	2-9
70-31350-01	Fan Assembly (92 mm)	2-11
70-31351-01	Fan Assembly (120 mm)	2-10
70-32283-01	Cable, Interlock/Server Management (2-Pin)	2-12
74-49172-05	Medallion, AlphaServer 1000A 4/266	1-13
74-49172-06	Medallion, AlphaServer 1000A 4/233	1-13
74-49172-08	Medallion, AlphaServer 1000A 5/300	1-13
74-49172-09	Medallion, AlphaServer 1000A 5/333	1-13
74-49172-10	Medallion, AlphaServer 1000A 5/400	1-13
74-49537-01	Cover, 5 1/4 Inch Panel	2-2
74-49538-01	Cover, 3 1/4 Inch Panel	2-3
74-50062-01	Key, Door (Not Shown)	2-25
74-50847-01	Door, AlphaServer 1000A	2-15
74-50848-01	Lens, Snap-In	2-16
90-00049-01	Screw, Sems Pan Hd No. 6-32 x 1/4	1-12
90-09984-20	Screw, Sems M 3.0 Pan 6 mm	1-10
90-09984-29	Screw, Sems M 3.5 Pan 8 mm	1-11
90-10961-02	Screw, Mach M3 Pan 6mm	1-14
EK-AL530-OG	Documentation, "Owner's Guide Supplement (EV5)" (Not Shown)	1-16
EK-ALPSV-OG	Documentation, "Owner's Guide" (Not Shown)	1-16
EK-ALPSV-SV	Documentation, "Service Guide" (Not Shown)	1-16
H8571-J	Adapter, DECstation 2000, 9-Pin Serial (Not Shown)	1-5
PB73A-A9	AlphaServer 1000A MODEL 4/233	1-A
PB74A-A9	AlphaServer 1000A MODEL 4/266	1-B
PB76A-A9	AlphaServer 1000A MODEL 5/333	1-D
PB77A-A9	AlphaServer 1000A MODEL 5/300	1-C
PB78A-A9	AlphaServer 1000A MODEL 5/400	1-E
PB7HA-BA	CABLE KIT, 16-Bit (Wide) SCSI	2-24
QC-01YAA-HC	Kit, EISA System Configuration (Not Shown)	1-9
RRD45-AA	CD-ROM (4X)	1-4
RX23L-AA	Floppy Drive, (3 1/2 Inch) 1.44 MB	2-18

INDEX BY DIGITAL PART DESCRIPTION

AlphaServer 1000A Series

DESCRIPTION	PART NUMBER	FIG.-ITEM NUMBER
Adapter, DECstation 2000, 9-Pin Serial (Not Shown)	H8571-J	1-5
AlphaServer 1000A MODEL 4/233	PB73A-A9	1-A
AlphaServer 1000A MODEL 4/266	PB74A-A9	1-B
AlphaServer 1000A MODEL 5/300	PB77A-A9	1-C
AlphaServer 1000A MODEL 5/333	PB76A-A9	1-D
AlphaServer 1000A MODEL 5/400	PB78A-A9	1-E
Backplane Assembly, StorageWorks	54-23365-01	2-8
CABLE ASSEMBLY, DC POWER SUPPLY	70-31346-01	2-4
Cable, Floppy Drive (34-Pin)	17-03970-02	2-14
Cable, Interlock/Server Management (2-Pin)	70-32283-01	2-12
Cable, Internal StorageWorks Jumper (68-Pin)	17-04021-01	2-22
CABLE KIT, 16-Bit (Wide) SCSI	PB7HA-BA	2-24
Cable, OCP Module (10-Pin)	17-03971-01	2-17
Cable, Power Supply Current Sharing (3-Pin)	17-04195-01	2-13
Cable, SCSI, 50 Cond. Daisychain, (MLB to Removable Media Devices to External Port)	17-04233-01	2-21
Cable, SCSI, 68 Cond. (MLB to StorageWorks)	17-04022-02	2-23
Cable, SCSI, 68 Cond. (Option Controller to StorageWorks)	17-04022-01	2-24B
Cable, SCSI, 68 Cond. (StorageWorks to External Port)	17-04019-01	2-24A
CD-ROM (4X)	RRD45-AA	1-4
Chip, NVRAM (E14) (Not Shown)	21-29631-02	2-25
Chip, NVRAM TOY Clock (E78) (Not Shown)	21-32423-01	2-25
Cover Assembly	70-31347-01	2-5
Cover, 3 1/4 Inch Panel	74-49538-01	2-3
Cover, 5 1/4 Inch Panel	74-49537-01	2-2
DESKSIDE TOWER (360 MM Width, 440 MM Height, 530 MM Depth)	30-41899-02	1-1, 2-A
Documentation, "Owner's Guide Supplement (EV5)" (Not Shown)	EK-AL530-OG	1-16
Documentation, "Owner's Guide" (Not Shown)	EK-ALPSV-OG	1-16
Documentation, "Service Guide" (Not Shown)	EK-ALPSV-SV	1-16
Door, AlphaServer 1000A	74-50847-01	2-15
Fan Assembly (120 mm)	70-31351-01	2-10
Fan Assembly (92 mm)	70-31350-01	2-11
Floppy Drive, (3 1/2 Inch) 1.44 MB	RX23L-AA	2-18
Harness, Power Supply +3.3V (20-Pin)	17-03968-01	2-4
Harness, Power Supply +5V (24-Pin)	17-03966-01	2-4
Harness, Power Supply Signal/Misc. (15-Pin)	17-03965-01	2-4
Harness, Power Supply Storage (12-Pin)	17-03969-01	2-4
Interlock Switch Assembly	70-31348-01	2-7
Jumper, StorageWorks, Split UNIBUS	12-14314-00	2-8A
Key, Door (Not Shown)	74-50062-01	2-25
Kit, EISA System Configuration (Not Shown)	QC-01YAA-HC	1-9
Label, "Customer Installation"	36-43629-02	1-3
Lens, Snap-In	74-50848-01	2-16

INDEX BY DIGITAL PART DESCRIPTION

AlphaServer 1000A Series

DESCRIPTION	PART NUMBER	FIG.-ITEM NUMBER
Medallion, AlphaServer 1000A 4/233	74-49172-06	1-13
Medallion, AlphaServer 1000A 4/266	74-49172-05	1-13
Medallion, AlphaServer 1000A 5/300	74-49172-08	1-13
Medallion, AlphaServer 1000A 5/333	74-49172-09	1-13
Medallion, AlphaServer 1000A 5/400	74-49172-10	1-13
Module, Alpha Processor, 233 MHz, EV45	54-23297-03	1-7
Module, Alpha Processor, 266 MHz, EV45	54-23297-04	1-7
Module, Alpha Processor, 300 MHz, EV5	54-24719-02	1-7
Module, Alpha Processor, 333 MHz, EV56	54-24799-02	1-7
Module, Alpha Processor, 400 MHz, EV56	54-24799-01	1-7
Module, Main Logic Board (MLB) (No Video)	54-23499-02	1-6
Module, Main Logic Board (MLB) (Video)	54-23499-01	1-6
Module, OCP	54-23302-01	2-6
Package Assembly (Not Shown)	37-01507-01	1-8
Panel Assembly, Front	70-31345-01	2-1
Power Cord (Australia, New Zealand) (BN19H-2E)	17-00198-14	1-15
Power Cord (Austria, Belgium, France, Germany, Finland, Holland, Norway, Sweden, Portugal, Spain (BN19C-2E)	17-00199-21	1-15
Power Cord (Denmark) (BN19K-2E)	17-00310-08	1-15
Power Cord (India, South Africa, Egypt) (BN19S-2E)	17-00456-16	1-15
Power Cord (Israel) (BN18L-2E)	17-00457-16	1-15
Power Cord (Italy) (BN19M-2E)	17-00364-18	1-15
Power Cord (Switzerland) (BN19E-2E)	17-00210-13	1-15
Power Cord (U.K., Ireland) (BN19A-2E)	17-00210-15	1-15
Power Cord (U.S., Japan, Canada) (BN26J-1K)	17-00083-09	1-15
Power Supply, 450W	30-43120-02	1-2
Screw, Mach M3 Pan 6mm	90-10961-02	1-14
Screw, Sems M 3.0 Pan 6 mm	90-09984-20	1-10
Screw, Sems M 3.5 Pan 8 mm	90-09984-29	1-11
Screw, Sems Pan Hd No. 6-32 x 1/4	90-00049-01	1-12
Speaker Assembly	70-31349-01	2-9
Terminator, 50 Pin SCSI, External	12-41667-05	2-19
Terminator, 68 Pin SCSI, Active, Internal	12-45490-01	2-20
Terminator, 68 Pin SCSI, External	12-41768-03	2-24C