



## ***Rackmount Keyboard Kit Installation Information***

### **EK-IODEV-IN. A01**

July 1999

### **Introduction**

The 2T-IODEV-LB/LK/VX (Blue/Gray/Black) rackmount keyboard kit contains the components for installing the slide assemblies, the cable carrier bracket, the keyboard tray, the keyboard, and the mouse in a 48.26-cm (19-in) EIA cabinet.

Table 1 lists the parts that are shipped with the 2T-IODEV-LB/LK/VX rackmount keyboard kit. The callouts in column 1 refer to the part location in Figure 1.

**Table 1 2T-IODEV-LB/LK/VX Rackmount Keyboard Kit Parts List**

<b>Figure 1 Callout</b>	<b>Description</b>	<b>Part Number</b>	<b>Qty.</b>
❶	Slide assembly	12-45276-01	1 pair
❷	Slide bracket	12-33984-01	4
❸	M4 x 10 mm pan-head screw	90-10556-01	14
❹	Flat washer, .190ID x .051THK	90-06660-00	8
❺	Split washer, .171ID	90-06690-00	8
❻	M4 hex nut	90-40133-05	8
❼	10-32 threaded nut bar	12-32830-01	4
❽	Right latch bracket	74-51323-01	1
❾	10-32 truss-head screw	90-00063-39	10
❿	Left latch bracket	74-51323-02	1
①	Cable carrier bracket	74-51322-01	1
②	Keyboard tray (Blue) or Keyboard tray (Gray) or Keyboard tray (Black)	70-32697-01 70-32697-02 70-32697-04	1 1 1
③	Compact 101-key keyboard	30-45229-01	1
④	3-Button mouse	SN-PBQWS-WA	1
⑤	Mouse pad	12-46327-01	1
	Tie wraps	90-07031-00	15
	<i>Rackmount Keyboard Kit Installation Information</i>	EK-IODEV-IN	1

© Compaq Computer Corporation. 1999. All Rights Reserved.

® Compaq and the Compaq logo are registered in the United States Patent and Trademark Office.

## Installing the Rackmount Keyboard Kit

The rackmount keyboard kit requires 4.45 cm (1.75 in.) (1U) of vertical space or three contiguous holes in a 48.26-cm (19-in) EIA cabinet. The bottom hole in this installation area is identified as hole 1 and the top hole is identified as hole 3.

In the following installation procedures, directions are referred to while viewing the components from the front of the cabinet. To install the rackmount keyboard kit, refer to Figure 1 and the following procedures:

1. Remove the inner races from the right and left slide assemblies ❶. Set the inner races aside.
2. Attach the right front slide bracket ❷ to the right slide assembly with two M4 x 10 mm pan-head screws ❸, flat washers ❹, split washers ❺, and M4 hex nuts ❻.
3. Attach the right rear slide bracket ❷ to the right slide assembly with two M4 x 10 mm pan-head screws ❸, flat washers ❹, split washers ❺, and M4 hex nuts ❻, but *do not* tighten.
4. Attach the left front slide bracket ❷ to the left slide assembly with two M4 x 10 mm pan-head screws ❸, flat washers ❹, split washers ❺, and M4 hex nuts ❻.
5. Attach the left rear slide bracket ❷ to the left slide assembly with two M4 x 10 mm pan-head screws ❸, flat washers ❹, split washers ❺, and M4 hex nuts ❻, but *do not* tighten.
6. Place the right front slide bracket ❷ on the inside of the right front rail and align two holes of the 10-32 nut bar ❶ with two slide bracket holes and with the 1st and 3rd holes of the installation area on the right front rail. Align two holes on the right latch bracket ❸ with the 1st and 3rd holes of the installation area on the front of the right front rail. Install two 10-32 truss-head screws ❹ in the 1st and 3rd holes of the installation area to secure the right front slide bracket and the right latch bracket to the right front rail.
7. Place the right rear slide bracket ❷ on the inside of the right rear rail and align two holes of the 10-32 nut bar ❶ with two slide bracket holes and with the 1st and 3rd holes of the installation area on the right rear rail. Install two 10-32 truss-head screws ❹ in the 1st and 3rd holes of the installation area to secure the right rear slide bracket to the right rear rail. Tighten the two M4 x 10 mm pan-head screws ❸ and M4 hex nuts ❻ that secure the right rear slide bracket to the right slide assembly.
8. Place the left front slide bracket ❷ on the inside of the left front rail and align two holes of the 10-32 nut bar ❶ with two slide bracket holes and with the 1st and 3rd holes of the installation area on the left front rail. Align two holes on the left latch bracket ❸ with the 1st and 3rd holes of the installation area on the front of the left front rail. Install two 10-32 truss-head screws ❹ in the 1st and 3rd holes of the installation area to secure the left front slide bracket and the left latch bracket to the left front rail.
9. Place the left rear slide bracket ❷ on the inside of the left rear rail and slide the end of the cable carrier bracket ❶ between the left rear slide bracket and the left rear rail. Align two holes of the 10-32 nut bar ❶ with two slide bracket holes and the two cable carrier holes, and with the 1st and 3rd holes of the installation area on the left rear rail. Install two 10-32 truss-head screws ❹ in the 1st and 3rd holes of the installation area to secure the left rear slide bracket and the cable carrier bracket to the left rear rail. Tighten the two M4 x 10 mm pan-head screws ❸ and M4 hex nuts ❻ that secure the left rear slide bracket to the left slide assembly.
10. Attach the right inner race ❷ to the right side of the keyboard tray ❷ with three M4 x 10 mm pan-head screws ❸.
11. Attach the left inner race ❷ to the left side of the keyboard tray ❷ with three M4 x 10 mm pan-head screws ❸.
12. Guide the keyboard cable through the slot in the rear of the keyboard compartment in the keyboard tray and place the keyboard ❸ in the keyboard compartment. Route the keyboard cable along the metal fingers and through the slot at the rear of the keyboard compartment and through the right cable slot on the rear of the keyboard tray after removing the rubber grommet. Cut the rubber grommet and place it around the keyboard cable, then slide the rubber grommet up the keyboard cable to remove the slack between the keyboard and the cable slot and insert the rubber grommet into the cable slot.

13. Guide the mouse cable through the slot in the rear of the mouse compartment in the keyboard tray and place the mouse ④ in the mouse compartment. Route the mouse cable through the slot at the rear of the mouse compartment and through the left cable slot on the rear of the keyboard tray after removing the rubber grommet. Cut the rubber grommet and place it around the mouse cable, then slide the rubber grommet up the mouse cable until there is enough slack between the mouse and the cable slot to allow the mouse to reach the mouse pad and insert the rubber grommet into the cable slot.
14. Place the mouse pad ⑤ in the mouse pad compartment of the keyboard tray.
15. Pull both slide assemblies out fully to their locked positions, then lift the keyboard tray and position it so that the inner races fit into the front end of the slide assemblies. Push the keyboard tray into the slide assemblies until it stops, then release the two locking levers and push the keyboard tray all the way into the cabinet.
16. Secure the other end of the cable carrier bracket ① to the left rear of the keyboard tray with two 10-32 truss-head screws ⑨.
17. Attach the keyboard and mouse cables to each end and the center of the front arm of the cable carrier bracket with three tie wraps and to each end and the center of the rear arm of the cable carrier bracket with three tie wraps.

**Figure 1 Installing the 2T-IODEV-LB/LK/VX Rackmount Keyboard Kit**

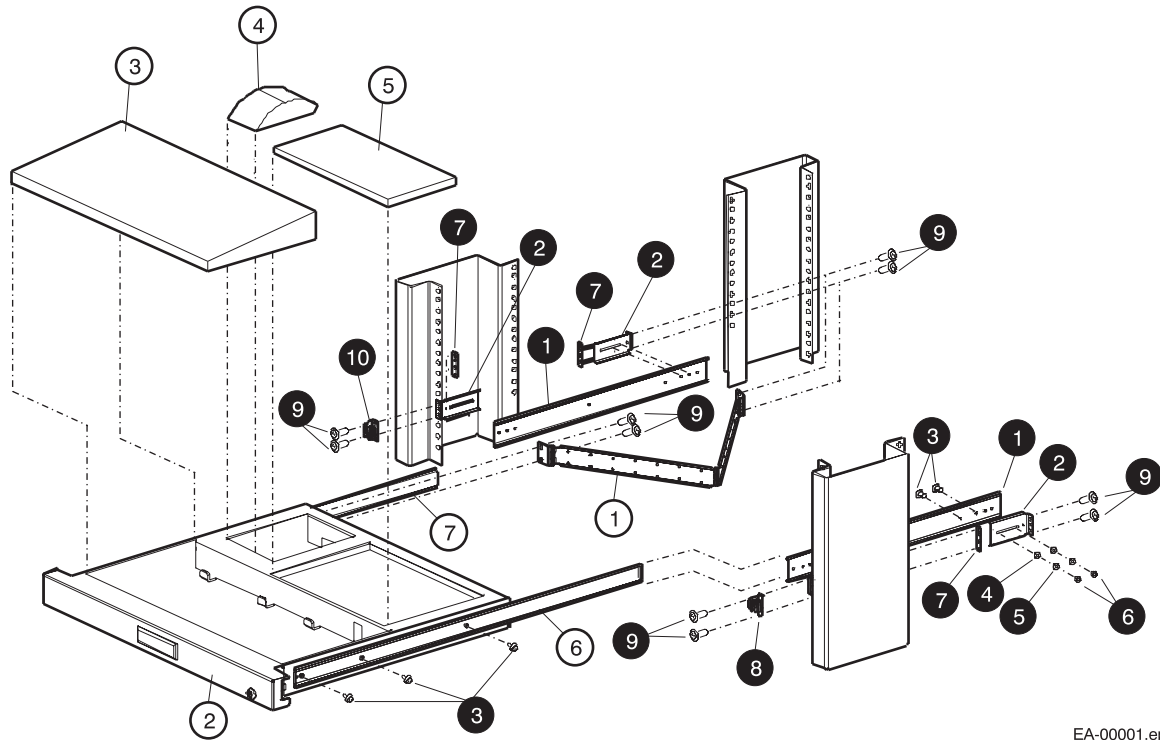

EA-00001.eps

